

Solid Wood FRAMELESS Kitchen Cabinetry (Made in the USA)

Specification/Prices Book

- Elegant Farmhouse Style
- Solid Maple Wood
- Soft Painted Finish
- Natural Interior and Matching Exterior Finishes
- Soft Close Doors & Drawers with Full Extension Glides



Newport



Vail



Hampton



Venice

Finish:

The doors are multi-step finished with two-part post-catalyzed conversion varnish. Formaldehyde free, high performance finish conversion varnish is used that is hard, heat resistant, chemical resistant, and has exceptional non-yellowing characteristics.

Conversion varnish is more durable and has a higher elasticity, which allows it to hold up better through wood joint expansion as compared to traditional lacquer. The carcasses are finished UV lacquer, which is durable, environmentally friendly and free from formaldehyde and hazardous substances.

This lacquer is not only safe but also kind to the environment at our production facilities. UV lacquer hardens when exposed to ultraviolet light. This makes the lacquer completely harmless and gives an attractive and robust finish that can tolerate even the roughest treatment.

Drawer Box:

The drawer boxes are constructed of solid wood with clear finishes and are connected with tight dovetail joints. All drawers come with a 1/4" plywood bottoms.

Shelving:

One full length Adjustable shelf comes with every 30" tall wall cabinets. Two shelves come with 36" tall wall cabinets and three come with 42" tall cabinets. Half-length adjustable shelving comes with every base cabinet. Shelves are made of 3/4" plywood and finished front and back.

Toe Kick:

Every base cabinet comes with 3/4" toe kick that is finished both ends. 96" x 4 1/2" x 5mm toe kicks are available as well.

Slides:

Side mounted full extension slides are used with Blum® hardware.

Hinges:

6-way adjustable, concealed, 110-degree soft closing hinges are used.

Soft closing hinges are not available for special cabinets such as lazy susans and diagonal corner cabinets.

GENERAL POLICY

A. Delivery Charges

1. For Assembled Cabinets

To store/warehouse: 6% of the invoice amount. Minimum charge is \$149.00 and Maximum charge is \$199.00

To job site, additional: \$75.00 (garage delivery only)

2. For Unassembled Cabinets (Flat Pack)

To store/warehouse: \$99.00

To job site: \$149.00(garage delivery only)

Above rate is only applied to deliveries located within 100 mile radius from the FERMA warehouse. For other shipping rates outside of this area, please call for freight rates.

B. Lead Time

25-30 working (business) days from date of order confirmation:

C. Order Placement

1. Customer must fill in the "ORDER FORM, and fax or email back to FERMA.
2. FERMA will send an Order Confirmation to the customer.
3. Customer must review and sign the Order Confirmation, and fax or email back to FERMA. No orders will be processed until a signed order confirmation is received
4. FERMA will advise lead time on signed order confirmation. Lead time starts from the day that the signed Order Confirmation is received.
5. **Please note that for assembled cabinet orders, you cannot make changes or cancel the order once FERMA receives a signed order confirmation.**

D. Returns / Exchanges

1. For Assembled Cabinets: cannot be returned or exchanged
2. For unassembled Cabinets in Flat Packaging: If cabinets were ordered unassembled in "flat packaging", it can be returned or exchanged within 30 days, and a 35% restocking fee applies on all approved returns. Returns and Exchanges must be in un-opened and resalable condition. Return goods authorization number (RA#) is required to process returns and exchanges. Additional freight charges will apply for pick up and return to FERMA

ORDER INSTRUCTION

A. To place an order

1. Orders may be placed using the order forms provided by FERMAWOOD CABINETRY.
2. All pages must be properly filled in when the orders are placed.
3. Specify shipping method (delivery or pick up), purchase order number and requested ship date. Assembled orders are normally ready to be shipped or picked up within 5-10 days of order confirmation.
4. If the order is to ship to a job site, then it must be noted as so along with a telephone number and contact person. Additional charges may apply.
5. FERMAWOOD CABINETRY schedules orders on a first in first out basis, according to your requested shipping schedule. If you foresee that you will have more than one order it would be best to batch your orders and then send them in at one time.
6. Rush orders may incur additional charges.
7. Pricing does not include freight. Contact your customer service representative for freight pricing for your area.
8. Please allow additional business days for completion of orders made with custom options and/or modifications.
9. Orders not picked up after four weeks will be stored at dealers' expense

B. Order Processing

1. FERMAWOOD CABINETRY will E-mail or fax an Order Confirmation you. If you do not receive an Order Confirmation within 6 hours of order placement, please contact us.
2. Customers are responsible for order accuracy, and should sign and Email or fax the Order Confirmation back to FERMAWOOD CABINETRY. Orders **will not be processed** until a signed Order Confirmation is received.

C. Change Order Procedure

We will consider requests for minor changes or cancellations to an order in writing up to 24 hour after receipt of your signed Order Confirmation. If your order has already been sent to the factory floor for assembly, additional fee will be required for the changes.

D. Shipping Shortages & Damages

Order shortages such as missing items and/or any visible shipping damages must be noted on the shipping receipt and signed by both the driver and the recipient. It is the customer's responsibility to notify FERMAWOOD CABINETRY of any such issues within 24 hours of accepting the delivery. Any orders accepted and signed by the customer without any such note, will be considered complete. All other shipping damages must be claimed by the customer within 5 days. All items that have been installed and/or are not in their original packaging cannot be claimed as damaged.

Style	Price Group
Newport	C
Vail	C
Gables	C
Hampton	C
Venice	C

Index					
Item #	Description		Item #	Description	
			FILLERS & PANELS		
AWC	Angled Wall Cabinet		BDP	Base Decorative Panel	
W	Wall Cabinet		BEP	Base End Panel	
WBC	Wall Blind Corner Cabinet		F	Filler	
WDC	Wall Diagonal Cabinet (end)		FBP	Finished Back Panel	
WEO	Wall End Open Shelf		FF	Fluted Filler	
			REP	Refrigerator End Panel	
BASE CABINETS			WDP	Wall Decorative Panel	
ASB	Angle Sink Base		MOULDING S		
B	Base Cabinet		ACM	Angle Crown Moulding	
BCB	Blind Corner Base		BM	Base Moulding	
BEC	Base End Cabinet (Open Shelf Type)		CCM	Classic Crown Moulding	
BPO	Base Pull Out		CVCM	Classic Cove Moulding	
BWR	Base Wine Rack		LMC	Light Moulding Classic	
DB	Drawer Base		LMS	Light Moulding Shaker	
LS	Lazy Susan Base		OCM	Outside Corner Moulding	
OC	Oven Cabinet		RTI	Ribbon Twist Insert	
SB	Sink Base		SDI	Small Dentil Moulding	
UC	Utility Cabinet		SM	Scribe Moulding	
			TK	Toe Kick	
ACCESSORIES			V	Valance	
CRBL	Corbel		VANITIES		
CRBLS	Corbel Shaker		VB	Vanity Base	
FSP	Fluted Square Post		VS	Vanity Sink Base	
GD	Glass Door		VDB	Vanity Drawer Base Cabinet	
GDAWC	Glass Door Angle Wall Cabinet		VKD	Vanity Knee Drawer	
Hinges	Hinges				
LSRoundMetal	Lazy Susan Insert(kidney)				
PO	Pull Out (Base Shelf)				
SP	Spindle Leg				
WBS	Waste Bin				
WCD	Wall China Display				
WR	Wine Rack				

Wall Cabinet 42"(Single Door)



Item	Width	Height	Depth	Price-C
W642	6	42	12	\$407
W942	9	42	12	\$453
W1242	12	42	12	\$542
W1542	15	42	12	\$602
W1842	18	42	12	\$664
W2142	21	42	12	\$742

W642 is only available with a slab door

Wall Cabinet 42"(Double Doors)

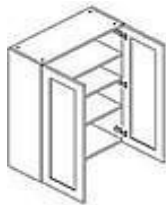

Item	Width	Height	Depth	Price-C
W2442	24	42	12	\$852
W2742	27	42	12	\$934
W3042	30	42	12	\$995
W3342	33	42	12	\$1,072
W3642	36	42	12	\$1,173

Wall Cabinets 36"(Single Door)



Item	Width	Height	Depth	Price-C
W636	6	36	12	\$349
W936	9	36	12	\$388
W1236	12	36	12	\$464
W1536	15	36	12	\$516
W1836	18	36	12	\$568
W2136	21	36	12	\$636

W 636 is only available with a slab door

Wall Cabinets 36"(Double Doors)

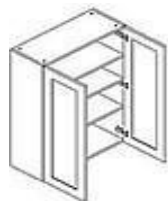

Item	Width	Height	Depth	Price-C
W2436	24	36	12	\$730
W2736	27	36	12	\$801
W3036	30	36	12	\$853
W3336	33	36	12	\$918
W3636	36	36	12	\$1,005

Wall Cabinets 30"(Single Door)



Item	Width	Height	Depth	Price-C
W630	6	30	12	\$298
W930	9	30	12	\$331
W1230	12	30	12	\$396
W1530	15	30	12	\$441
W1830	18	30	12	\$486
W2130	21	30	12	\$543

W 630 is only available with a slab door

Wall Cabinets 30"(Double Doors)

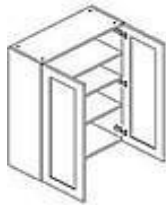

Item	Width	Height	Depth	Price-C
W2430	24	30	12	\$624
W2730	27	30	12	\$684
W3030	30	30	12	\$729
W3330	33	30	12	\$785
W3630	36	30	12	\$859

Wall Cabinets 24", 21", 18", 15, 12" Height (Double Doors)



Item	Width	Height	Depth	Price-C
W3024	30	24	12	\$579
W362412	36	24	12	\$703
W362424	36	24	24	\$869
W3021	30	21	12	\$527
W3321	33	21	12	N/A
W3018	30	18	12	\$475
W3318	33	18	12	\$494
W3618	36	18	12	\$571
W361824	36	18	24	\$760
W3015	30	15	12	\$443
W3315	33	15	12	\$467
W3615	36	15	12	\$491
W3012	30	12	12	\$404
W3312	33	12	12	\$421
W3612	36	12	12	\$439
W361224	36	12	24	\$652

Wall Blind Corner Cabinet 42"



Item	Width	Height	Depth	Price-C
WBC2742	27	42	11 ¾	\$934
WBC3042	30	42	11 3/4	\$1121
WBC3342	33	42	11 3/4	\$1,224

Wall Blind Corner Cabinet 36"



Item	Width	Height	Depth	Price-C
WBC2736	27	36	12	\$881
WBC3036	30	36	12	\$984
WBC3336	33	36	12	\$1,086

Wall Blind Corner Cabinet 30"



Item	Width	Height	Depth	Price-C
WBC2730	27	30	12	\$881
WBC3330	33	30	12	\$986

Angle Wall Cabinet 12" & 15" Deep



Item	Width	Height	Depth	Price-C
AWC2430	24	30	12	\$832
AWC2436	24	36	12	\$974
AWC2442	24	42	12	\$1,116
AWC273615	27	36	15	\$1123
AWC274215	27	42	15	\$1,315

Wall End Open Shelf



Item	Width	Height	Depth	Price-C
WEOS930	9	30	12	\$324
WEOS936	9	36	12	\$379
WEOS1242	12	42	12	\$486

Wall Diagonal Cabinet



Item	Width	Height	Depth	Price-C
WDC1230	12	30	12	\$563
WDC1236	12	36	12	\$676
WDC1242	12	42	12	\$789

Base Cabinets (Single Door)

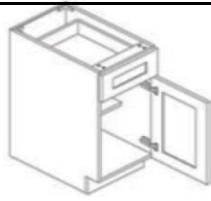

Item	Width	Height	Depth	Price-C
B6	6	34 1/2	24	\$343
B9	9	34 1/2	24	\$449
B12	12	34 1/2	24	\$516
B15	15	34 1/2	24	\$582
B18	18	34 1/2	24	\$637
B21	21	34 1/2	24	\$691

B6 is only available with a Full Height Slab door

Base Cabinets (Double Doors)



Item	Width	Height	Depth	Price-C
B24	24	34 1/2	24	\$734
B27	27	34 1/2	24	\$832
B30	30	34 1/2	24	\$885

Base Cabinets (Double Doors w/ Double Drawers)



Item	Width	Height	Depth	Price-C
B33	33	34 1/2	24	\$932
B36	36	34 1/2	24	\$986

Drawer Base Cabinets



Item	Width	Height	Depth	Price-C
DB 12-3	12	34 1/2	24	\$807
DB 15-3	15	34 1/2	24	\$844
DB 18-3	18	34 1/2	24	\$885
DB 21-3	21	34 1/2	24	\$982
DB 24-3	24	34 1/2	24	\$1,035
DB 27-3	27	34 1/2	24	\$1,055
DB 30-3	30	34 1/2	24	\$1,069
DB 33-3	33	34 1/2	24	\$1,132
DB 36-3	36	34 1/2	24	\$1,199

Base Blind Corner Cabinets

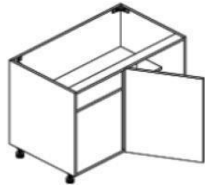

Item	Width	Height	Depth	Price-C
BCB39	39	34 1/2	24	\$1,046
BCB42	42	34 1/2	24	\$1,122
BCB45	45	34 1/2	24	\$1,193

Sink Base Cabinets



Item	Width	Height	Depth	Price-C
SB30	30	34 1/2	24	\$863
SB33	33	34 1/2	24	\$918
SB36	36	34 1/2	24	\$971

Angle Base Cabinets



Item	Width	Height	Depth	Price-C
ASB 36	36	34 1/2	24	\$1,399
ASB 42	42	34 1/2	24	\$1,528

Lazy Susan Base Cabinet

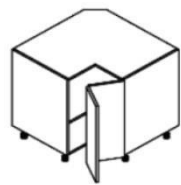

Item	Width	Height	Depth	Price-C
LS33	33	34 1/2	24	\$1,326
LS36	36	34 1/2	24	\$1,427

Lazy Susan Metal Rack sold separately, see accessories. Plywood shelves included.

Base Pull Out

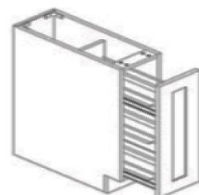

Item	Width	Height	Depth	Price-C
BPO6	6	34 1/2	24	\$601
BPO9	9	34 1/2	24	\$683

Base Wine Rack

	Item	Width	Height	Depth	Price-C
	BWR 6	6	34 1/2	24	\$400



Base End Cabinet

	Item	Width	Height	Depth	Price-C
	BEC 9 R/L	9	34 1/2	24	\$427

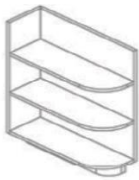

Utility Cabinet

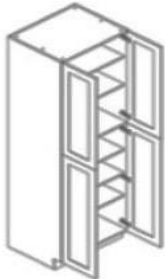

Utility Cabinet 96" (Pullouts available)

Item	Width	Height	Depth	Price-C
UC 1896	18	96	24	\$2,071
UC 2496	24	96	24	\$2,174
UC 3096	30	96	24	\$2,460

Utility Cabinet 90" (Pullouts available)

Item	Width	Height	Depth	Price-C
UC 1890	18	90	24	\$1,918
UC 2490	24	90	24	\$2,129
UC 3090	30	90	24	\$2,282

Utility Cabinet 84" (Pullouts available)

Item	Width	Height	Depth	Price-C
UC 1884	18	84	24	\$1,758
UC 2484	24	84	24	\$1,930
UC 3084	30	84	24	\$2,132

Oven Cabinet

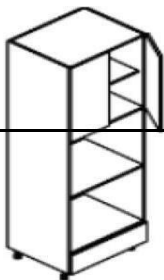

Oven Cabinet 96"

Item	Width	Height	Depth	Price-C
OC 3096	30	96	24	\$2,562

Oven Cabinet 90"

Item	Width	Height	Depth	Price-C
OC 3090	30	90	24	\$2,440

Oven Cabinet 84"

Item	Width	Height	Depth	Price-C
OC 3084	30	84	24	\$2,306

Vanity Base

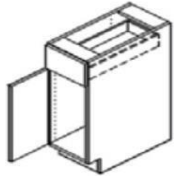

Item	Width	Height	Depth	Price-C
VB-15	15	34 1/2	21	\$564
VB-18	18	34 1/2	21	\$618
VB-21	21	34 1/2	21	\$672

Vanity Sink Base



Item	Width	Height	Depth	Price-C
VS-24	24	34 1/2	21	\$811
VS-30	30	34 1/2	21	\$863
VS-36	36	34 1/2	21	\$971

Vanity Drwer Base Cabinet

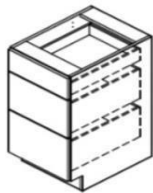

Item	Width	Height	Depth	Price-C
VDB12-3	12	34 1/2	21	\$822
VDB15-3	15	34 1/2	21	\$861
VDB18-3	18	34 1/2	21	\$904

Vanity Knee Drawer



Item	Width	Height	Depth	Price-C
VKD24	24	7	21	\$155
VKD30	30	7	21	\$170

Wine Rack

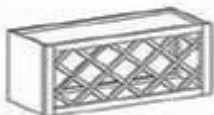

Item	Width	Height	Depth	Price-C
WR 3612	36	12	12	\$557
WR 3615	36	15	12	\$580

Wine Rack

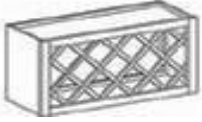
	Item	Width	Height	Depth	Price-C
	WR 3612	36	12	12	\$557
	WR 3615	36	15	12	\$580

Wall China Display

	Item	Width	Height	Depth	Price-C
	WCD 3615	36	15	12	\$788

Pull Outs

	Item	Width	Height	Depth	Price-C
	PO 18	18	3	20	\$245
	PO 21	21	3	20	\$278
	PO 24	24	3	20	\$291
	PO 27	27	3	20	\$306
	PO 30	30	3	20	\$343
	PO 36	36	3	20	\$380

Full extension Slides Included in natural finish

Lazy Susan Inserts (Kidneys)

Item	Size	Price-C
LS Round Metal 33	33	\$71
LS Round Metal 36	36	\$71
*Metal Shelves		
LS Round Poly 33	33	\$72
LS Round Poly 36	36	\$87
*Plastic Shelves		
LS Round Wood 33	33	\$464
LS Round Wood 36	36	\$464
*Wooden Shelves		

Self Close Hinges

Item	Price-C
Hinges	\$12

Fillers 3"

	Item	Width	Height	Depth	Price-C
	F330	3	30	3/4	\$108
	F336	3	36	3/4	\$128
	F342	3	42	3/4	\$152
	F396	3	96	3/4	\$342

Filler's 6"

	Item	Width	Height	Depth	Price-C
	F630	6	30	3/4	\$256
	F636	6	36	3/4	\$272
	F642	6	42	3/4	\$300
	F696	6	96	3/4	\$684

Fluttered Fillers 3"

	Item	Width	Height	Depth	Price-C
	FF330	3	30	3/4	\$110
	FF336	3	36	3/4	\$110
	FF342	3	42	3/4	\$128
	FF384	3	84	3/4	\$279
	FF390	3	90	3/4	\$299
	FF396	3	96	3/4	\$319

Fluttered Fillers 6"

	Item	Width	Height	Depth	Price-C
	FF630	3	30	3/4	\$188
	FF636	3	36	3/4	\$219
	FF642	3	42	3/4	\$255
	FF684	3	84	3/4	\$462
	FF690	3	90	3/4	\$495
	FF696	3	96	3/4	\$532

Base End Panel

	Item	Width	Height	Depth	Price-C
	BEP	3/4	34 1/2	23 3/4	\$243

Refridgerator End Panel

	Item	Width	Height	Depth	Price-C
	REP 3696	36	96	3/4	\$677

Finish Back Panel

	Item	Width	Height	Depth	Price-C
	FBP4896	96	48	1/8	\$449

Toe Kick

	Item	Width	Height	Depth	Price-C
	TK 96	96	4 1/2	1/8	\$98

Base Molding

	Item	Width	Height	Depth	Price-C
	BM 96	96	4 1/2	3/4	\$316

Scribe Molding

	Item	Width	Height	Depth	Price-C
	SM 96	96	3/4	1/4	\$103

Outside Corner Molding

	Item	Width	Height	Depth	Price-C
	OCM 96	96	3/4	1/4	\$149

Classic Crown Molding

	Item	Width	Height	Depth	Price-C
	CCM	96	3 3/4	3/4	\$330

CCM not available in Toscana / Modena / Hampton / Madison

Classic Cove Molding

	Item	Width	Height	Depth	Price-C
	CVCM	96	3 3/4	3/4	\$330

Angle Crown Molding

	Item	Width	Height	Depth	Price-C
	ACM	96	3 3/4	3/4	\$456
	<i>ACM not available in Prestige / Lexington / Camden / Rockport / Boardwalk</i>				

Small Dentil Insert

	Item	Width	Height	Depth	Price-C
	SDI	96	1	1/2	\$72
	<i>SDI not available in Toscana / Modena / Hampton / Madison</i>				

Ribbon Twist Insert

	Item	Width	Height	Depth	Price-C
	RTI	96	1	1/2	\$75
	<i>RTI not available in Toscana / Modena / Hampton / Madison</i>				

Light Moulding Classic

	Item	Width	Height	Depth	Price-C
	LMC	96	2	3/4	\$234

Light Moulding Shaker

	Item	Width	Height	Depth	Price-C
	LMS	96	2	3/4	\$234
	<i>LMS not available in Prestige, Rockport, Lexington, Camden</i>				

Valance

	Item	Width	Height	Depth	Price-C
	VS36	36	5 1/2	3/4	\$295
	VS48	48	5 1/2	3/4	\$331
	VS60	60	5 1/2	3/4	\$367

Corbel

	Item	Width	Height	Depth	Price-C
	CRBL	5	10	5 3/4	1084
	CRBL not available in Toscana / Modena / Hampton / Madison				

Corbel Shaker

	Item	Width	Height	Depth	Price-C
	CRBLS	5	10	5 3/4	\$1117
	CRBLS not available in Toscana / Modena / Hampton / Madison				

Spindel Leg

	Item	Width	Height	Depth	Price-C
	SP 4	4 3/4	42	4 3/4	\$1165
	SP4 not available in Toscana / Modena / Hampton / Madison				

Flute Square Post

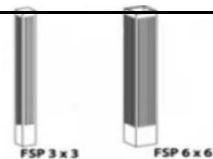
	Item	Width	Height	Depth	Price-C
	FSP 3X3	3	34 1/2	3	\$487
	FSP 6X6	6	34 1/2	6	\$927
	FSP not available in Toscana / Modena / Hampton / Madison				

Waste Bin

	Item	Width	Height	Depth	Price-C
	WBS	17 3/4	10 1/4	20 1/2	\$157
	WBD	21	16 1/2	20 1/2	\$211

*WBS: Single waste bin, fits B15 and bigger cabinets

*WBD: Double waste bin, fits B21 and bigger cabinets

SINGLE WASTE BIN

DOUBLE WASTE BINS

Base Decorative Panel

	Item	Width	Height	Depth	Price-C
	BDP2430	23 7/8	29 7/8	3/4	\$648

Wall Decorative Panel

	Item	Width	Height	Depth	Price-C
	WDP 1230	11 7/8	29 7/8	3/4	\$384
	WDP 1236	11 7/8	35 7/8	3/4	\$435
	WDP 1242	11 7/8	41 7/8	3/4	\$487

Glass Doors

	Item	Width	Height	Depth	Price-C
	GD 1230	11 7/8	29 7/8	3/4	\$594
	GD 1530	14 7/8	29 7/8	3/4	\$661
	GD 1830	17 7/8	29 7/8	3/4	\$729
	GD 1236	11 7/8	35 7/8	3/4	\$696
	GD 1536	14 7/8	35 7/8	3/4	\$774
	GD 1836	17 7/8	35 7/8	3/4	\$852
	GD 1242	11 7/8	41 7/8	3/4	\$813
	GD 1542	14 7/8	41 7/8	3/4	\$903
	GD 1842	17 7/8	41 7/8	3/4	\$996

*Mullions are not available in Hampton,

Glass Doors Angle Wall Cabinets

	Item	Width	Height	Depth	Price-C
	GD AWC 243012	16	29 7/8	3/4	\$1248
	GD AWC 243612	16	35 7/8	3/4	\$1461
	GD AWC 244212	16	41 7/8	3/4	\$1674
	GD AWC 273615	16-5/8	35 7/8	3/4	\$1684
	GD AWC 274215	16-5/8	41 7/8	3/4	\$1972

*Mullions are not available in Hampton,

Limited Liability Warranty

FERMAWOOD CABINETRY, warrants its WOODTREND Cabinetry ("the Products") to be free of manufacturer defects for five (5) years from the date of purchase by the original purchaser, but products with painted finishes are limited to two (2) year warranty, or as long as the original purchasing consumer owns the home, whichever is less, against avoidable and unnatural defects in material and workmanship under normal use.

This limited warranty applies to domestic use only, is non-transferable, and proof of purchase is required.

This warranty does not cover the products that have been misused, mishandled, abused, improperly stored or installed, modified or subject to excesses of moisture or extreme temperatures, accidents, negligence, on-site alterations, improper storage, defective installation, or normal wear and tear. The products must be used exclusively for its intended purpose in order to be covered by this warranty. This warranty shall become void if the products are in any way modified, improperly installed or damaged prior to or during installation, or installed or utilized in other than normal residential applications.

This warranty does not include or cover the cost of installation, removal, subsequent damage or transportation of the defective product, regardless of whether work was performed by a contractor, service company, or homeowner or any other end users

This warranty does not apply to any other products used in conjunction with the products (cabinetry), such as, but not limited to flooring, countertops, appliances, or plumbing fixtures.

The obligation of FERMAWOOD CABINETRY, under this warranty shall be only limited to the repair or exchange of any part or parts that the products deems proven defective under normal use and service within the warranty period. If a defect does occur within the terms and conditions of this warranty such defective part will be repaired or replaced by FERMAWOOD CABINETRY at its sole discretion. FERMAWOOD CABINETRY will not provide or pay for the cost of removal of defective product, transportation of defective, repaired or replaced product or installation of repaired or replaced product. FERMAWOOD CABINETRY will not be responsible for any shipping damages to the defective, replaced or repaired product. The product line and specifications of Signature Tradition Cabinetry may periodically be changed or discontinued. If defective item has been discontinued or is not available at the time, FERMAWOOD CABINETRY reserves the right to replace the item with the most similar item available in its inventory at that time. Some replacement parts are subject to availability, and they may differ from those originally supplied. FERMAWOOD CABINETRY can NOT guarantee that the finish of any replacement will exactly match the finish and appearance of the defective item due to the natural aging process of the wood and finishes of the cabinets. Accordingly, FERMAWOOD CABINETRY will NOT be held responsible for replacing products that may not exactly match installed products

The products of WOODTREND Cabinetry are constructed from several pieces of solid wood and wood veneers on plywood. Differences in grain pattern and color should be expected. Wood characteristics naturally occurring such as variations in color, grain, mineral streaks and knots, are not considered defects. Color variations and color softening in cabinets are a natural occurrence due to wood species, age, character of cabinets, and exposure to UV light and sunlight. For these reasons, new and/or replacement

cabinets may not match display samples and/or existing cabinets. Therefore, such variations and changes are NOT considered defects.

This warranty applies only to defects and does not apply to the yellowing and aging of any wood product. The products of Signature Tradition Cabinetry are wood products. Extreme conditions will cause any wood product to respond adversely (high/low humidity, temperature, etc.) and this warranty does not apply to cabinetry exposed to extreme conditions. Mitered doors joint in particular are more likely to react to conditions of its environment. Gaps that may develop in door joints due to conditions of its environment are not subject to replacement under this warranty. Painted finishes reacting differently than stained finish with normal wood movement and climatic conditions, may result in breaks in finish, recesses, and joint and panel lines. These features are considered normal occurrence and not covered under this warranty.

Wood by nature will undergo expansion and contraction movements year after year as it compensates and adjusts to ever changing atmospheric humidity and temperature conditions. It is common for center panels on doors to shrink, expand or move during these transitions. Typically, the panel will return to its normal position within a year once it has adjusted to seasonal changes. It is for these same reasons that it is common for doors to warp during these periods. Therefore, doors that are warped in either direction not exceeding one-quarter inch (1/4") do not exceed normal material expectation and they are not covered under the terms of this warranty.

Warranty claims are only filed to FERMAWOOD CABINETRY by dealer or distributors from whom the products were purchased. To submit a warranty claim, the original purchaser must contact FERMAWOOD CABINETRY's dealer or distributor where the product was purchased. The independent dealer or distributor will obtain the information necessary to make a claim decision and forward such information in writing to FERMAWOOD CABINETRY for action on the claim.

This writing is the complete and exclusive statement of the express warranties provided herein and is in lieu of all other express and/or statutory warranties by the manufacturer, to the extent provided by law. There are no implied warranties extending beyond the terms of this warranty. FERMAWOOD CABINETRY shall not be liable for any incidental or consequential costs, expenses or damages.