

## Dealer Price List

Effective 10/15/2014

Woodtrend Collection (Traditional Series)										
Style	Price Group	Model #		Style	Price Group	Model #		Style	Price Group	Model #
Prestige	A	AW-P		Camden	B	AW-C		Aspen	C	AW-A
Sahara	A	AW-S		Lexington	B	AW-L		Boardwalk	C	AW-B
				Rockport	B	AW-R		Hampton	C	AW-H
				Toscana	B	AW-T		Madison	C	AW-M

Index									
Item #	Description	Page		Item #	Description	Page			
WALL CABINETS				FILLERS & PANELS					
AWC	Angled Wall Cabinet	6		BDP	Base Decorative Panel	17			
W	Wall Cabinet	4,5		BEP	Base End Panel	14			
WBC	Wall Blind Corner Cabinet	6		F	Filler	13			
WDC	Wall Diagonal Cabinet (end)	6		FBP	Finished Back Panel	14			
WEO	Wall End Open Shelf	6		FF	Filuted Filler	13			
				REP	Refridgerator End Panel	14			
BASE CABINETS				WDP	Wall Decorative Panel	17			
ASB	Angle Sink Base	8		MOULDINGS					
B	Base Cabinet	7		ACM	Angle Crown Moulding	14			
BCB	Blind Corner Base	8		BM	Base Moulding	14			
BEC	Base End Cabinet (Open Shelf Type)	9		CCM	Classic Crown Moulding	14			
BPO	Base Pull Out	8		CVCM	Classic Cove Moulding	14			
BWR	Base Wine Rack	9		LMC	Light Moulding Classic	15			
DB	Drawer Base	7		LMS	Light Moulding Shaker	15			
LS	Lazy Susan Base	8		OCM	Outside Corner Moulding	14			
OC	Oven Cabinet	10		RTI	Ribbon Twist Insert	15			
SB	Sink Base	8		SDI	Small Dentil Moulding	15			
UC	Utility Cabinet	10		SM	Scribe Moulding	14			
				TK	Toe Kick	14			
ACCESSORIES				V	Valance	15			
CRBL	Corbel	16		VANITIES					
CRBLS	Corbel Shaker	16		VB	Vanity Base	11			
FSP	Flutted Square Post	16		VSB	Vanity Sink Base	11			
GD	Glass Door	17		VDB	Vanity Drawer Base Cabinet	11			
GDAWC	Glass Door Angle Wall Cabinet	17		VKD	Vanity Knee Drawer	11			
Hinges	Hinges	12							
LSRoundMetal	Lazy Susan Insert(kidney)	12							
PO	Pull Out (Base Shelf)	12							
SP	Spindel Leg	16							
WBS	Waste Bin	16							
WCD	Wall China Display	12							
WR	Wine Rack	12							

## GENERAL POLICY

### A. Delivery Charges

#### 1. For Assembled Cabinets

To Store: 6% of the invoice amount. Minimum charge is \$149 and Maximum charge is \$199  
To Job Site: Additional \$75 surcharge (garage delivery only)

#### 2. For Unassembled cabinets (Flat Pack)

To store/warehouse: \$99  
To job site: \$149 (garage delivery only)

*Above rate is only applied to deliveries located within 100 mile radius from the FERMA warehouse.  
For other shipping rates outside of this area, please call for freight rates.*

### B. Lead Time

**7 working days** from date of order confirmation:  
Sahara, Camden, Rockport, Madison, Hampton, Boardwalk and Aspen.

**14 working days** from date of order confirmation:  
Lexington, Prestige, Toscana

### C. Order Placement

1. Customer must fill in the "ORDER FORM, and fax or email back to FERMA.
2. FERMA will send an Order Confirmation to the customer.
3. Customer must review and sign the Order Confirmation, and fax or email back to FERMA. No orders will be processed until a signed order confirmation is received
4. FERMA will advise lead time on signed order confirmation. Lead time starts from the day that the signed Order Confirmation is received.
5. **Please note that for assembled cabinet orders, you cannot make changes or cancel the order once FERMA receives a signed order confirmation.**

### D. Returns / Exchanges

1. For Assembled Cabinets: cannot be returned or exchanged
2. For unassembled Cabinets in Flat Packaging: If cabinets were ordered unassembled in "flat packaging", it can be returned or exchanged within 30 days, and a 25% restocking fee applies on all approved returns. Returns and Exchanges must be in un-opened and resalable condition. Return goods authorization number (RA#) is required to process returns and exchanges. Additional freight charges will apply for pick up and return to FERMA.

## **ORDER INSTRUCTION**

### **A. To place an order**

1. Orders may be placed using the order forms provided by FERMAWOOD CABINETRY.
2. All pages must be properly filled in when the orders are placed.
3. Specify shipping method (delivery or pick up), purchase order number and requested ship date. Assembled orders are normally ready to be shipped or picked up within 5-7 business days.
4. If the order is to ship to a job site, then it must be noted as so along with a telephone number and contact person. Additional charges may apply.
5. FERMAWOOD CABINETRY schedules orders on a first in first out basis, according to your requested shipping schedule. If you foresee that you will have more than one order it would be best to batch your orders and then send them in at one time.
6. Rush orders may incur additional charges.
7. Pricing does not include freight. Contact your customer service representative for freight pricing for your area.
8. Please allow additional business days for completion of orders made with custom options and/or modifications.
9. Orders not picked up after four weeks will be stored at dealers' expense

### **B. Order Processing**

1. FERMAWOOD CABINETRY will E-mail or fax an Order Confirmation you. If you do not receive an Order Confirmation within 6 hours of order placement, please contact us.
2. Customers are responsible for order accuracy, and should sign and Email or fax the Order Confirmation back to FERMAWOOD CABINETRY. Orders will not be processed until a signed Order Confirmation is received.

### **C. Change Order Procedure**

We will consider requests for minor changes or cancellations to an order in writing up to 24 hours after receipt of your signed Order Confirmation. If your order has already been sent to the factory floor for assembly, additional fee will be required for the changes.

### **D. Shipping Shortages & Damages**

Order shortages such as missing items and/or any visible shipping damages must be noted on the shipping receipt and signed by both the driver and the recipient. It is the customer's responsibility to notify FERMAWOOD CABINETRY of any such issues within 24 hours of accepting the delivery. Any orders accepted and signed by the customer without any such note, will be considered complete. All other shipping damages must be claimed by the customer within 5 days. All items that have been installed and/or are not in their original packaging cannot be claimed as damaged.

### Wall Cabinet 42"(Single Door)



Item	Width	Height	Depth	A	B	C
W642	6	42	12	N/A	\$370	\$407
W942	9	42	12	N/A	\$411	\$453
W1242	12	42	12	N/A	\$492	\$542
W1542	15	42	12	N/A	\$547	\$602
W1842	18	42	12	N/A	\$603	\$664
W2142	21	42	12	N/A	\$674	\$742

W642 is only available with a slab door

### Wall Cabinet 42"(Double Doors)

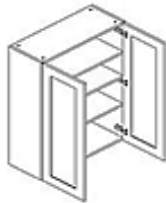

Item	Width	Height	Depth	A	B	C
W2442	24	42	12	N/A	\$774	\$852
W2742	27	42	12	N/A	\$849	\$934
W3042	30	42	12	N/A	\$904	\$995
W3342	33	42	12	N/A	\$974	\$1,072
W3642	36	42	12	N/A	\$1,066	\$1,173

### Wall Cabinets 36"(Single Door)

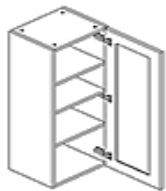

Item	Width	Height	Depth	A	B	C
W636	6	36	12	\$280	\$317	\$349
W936	9	36	12	\$311	\$352	\$388
W1236	12	36	12	\$373	\$422	\$464
W1536	15	36	12	\$414	\$469	\$516
W1836	18	36	12	\$457	\$517	\$568
W2136	21	36	12	\$510	\$578	\$636

W 636 is only available with a slab door

### Wall Cabinets 36"(Double Doors)

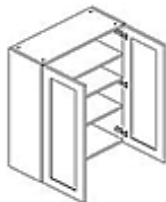

Item	Width	Height	Depth	A	B	C
W2436	24	36	12	\$585	\$663	\$730
W2736	27	36	12	\$643	\$728	\$801
W3036	30	36	12	\$684	\$775	\$853
W3336	33	36	12	\$737	\$835	\$918
W3636	36	36	12	\$807	\$914	\$1,005

### Wall Cabinets 30"(Single Door)



Item	Width	Height	Depth	A	B	C
W630	6	30	12	\$239	\$271	\$298
W930	9	30	12	\$266	\$301	\$331
W1230	12	30	12	\$318	\$360	\$396
W1530	15	30	12	\$354	\$401	\$441
W1830	18	30	12	\$390	\$442	\$486
W2130	21	30	12	\$436	\$494	\$543

W 630 is only available with a slab door

### Wall Cabinets 30"(Double Doors)

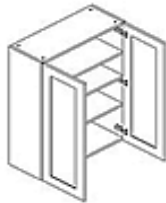

Item	Width	Height	Depth	A	B	C
W2430	24	30	12	\$501	\$567	\$624
W2730	27	30	12	\$549	\$622	\$684
W3030	30	30	12	\$585	\$662	\$729
W3330	33	30	12	\$630	\$713	\$785
W3630	36	30	12	\$690	\$781	\$859

### Wall Cabinets 24", 21", 18", 15, 12" Height (Double Doors)



Item	Width	Height	Depth	A	B	C
W3024	30	24	12	\$465	\$527	\$579
W362412	36	24	12	N/A	\$639	\$703
W362424	36	24	24	N/A	\$790	\$869
W3021	30	21	12	\$423	\$479	\$527
W3321	33	21	12	N/A	N/A	N/A
W3018	30	18	12	\$382	\$432	\$475
W3318	33	18	12	\$397	\$449	\$494
W3618	36	18	12	\$458	\$519	\$571
W361824	36	18	24	\$610	\$691	\$760
W3015	30	15	12	\$356	\$403	\$443
W3315	33	15	12	\$374	\$424	\$467
W3615	36	15	12	\$393	\$446	\$491
W3012	30	12	12	\$324	\$367	\$404
W3312	33	12	12	\$352	\$383	\$421
W3612	36	12	12	\$352	\$399	\$439
W361224	36	12	24	\$524	\$593	\$652

### Wall Blind Corner Cabinet 42"



Item	Width	Height	Depth	A	B	C
WBC2742	27	42	12	N/A	\$904	\$934
WBC3342	33	42	12	N/A	\$1,083	\$1,072

### Wall Blind Corner Cabinet 36"



Item	Width	Height	Depth	A	B	C
WBC2736	27	36	12	\$707	\$801	\$881
WBC3036	30	36	12	N/A	N/A	N/A
WBC3336	33	36	12	\$872	\$988	\$1,086

### Wall Blind Corner Cabinet 30"

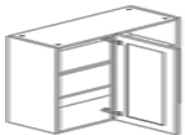

Item	Width	Height	Depth	A	B	C
WBC2730	27	30	12	\$707	\$801	\$881
WBC3330	33	30	12	N/A	N/A	N/A

### Angle Wall Cabinet 12" & 15" Deep



Item	Width	Height	Depth	A	B	C
AWC2430	24	30	12	\$668	\$757	\$832
AWC2436	24	36	12	\$782	\$885	\$974
AWC2442	24	42	12	N/A	\$1,014	\$1,116
AWC273615	27	36	15	\$751	\$851	\$936
AWC274215	27	42	15	\$923	\$996	\$1,096

### Wall End Open Shelf

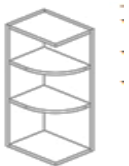

Item	Width	Height	Depth	A	B	C
WEOS930	9	30	12	\$260	\$294	\$324
WEOS936	9	36	12	\$304	\$344	\$379
WEOS1242	12	42	12	N/A	\$441	\$486

### Wall Diagonal Cabinet



Item	Width	Height	Depth	A	B	C
WDC1230	12	30	12	\$452	\$512	\$563
WDC1236	12	36	12	\$543	\$615	\$676
WDC1242	12	42	12	N/A	\$717	\$789

### Base Cabinets (Single Door)

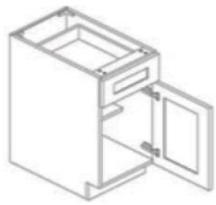

Item	Width	Height	Depth	A	B	C
B6	6	34 1/2	24	\$276	\$312	\$343
B9	9	34 1/2	24	\$360	\$408	\$449
B12	12	34 1/2	24	\$414	\$469	\$516
B15	15	34 1/2	24	\$467	\$529	\$582
B18	18	34 1/2	24	\$511	\$579	\$637
B21	21	34 1/2	24	\$555	\$629	\$691

*B6 is only available with a Full Height Slab door*

### Base Cabinets (Double Doors)



Item	Width	Height	Depth	A	B	C
B24	24	34 1/2	24	\$590	\$668	\$734
B27	27	34 1/2	24	\$668	\$756	\$832
B30	30	34 1/2	24	\$710	\$804	\$885

### Base Cabinets (Double Doors w/ Double Drawers)

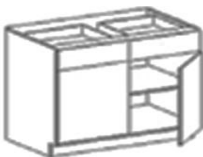

Item	Width	Height	Depth	A	B	C
B33	33	34 1/2	24	\$748	\$847	\$932
B36	36	34 1/2	24	\$791	\$896	\$986

### Drawer Base Cabinets



Item	Width	Height	Depth	A	B	C
DB 12-3	12	34 1/2	24	\$648	\$734	\$807
DB 15-3	15	34 1/2	24	\$677	\$767	\$844
DB 18-3	18	34 1/2	24	\$710	\$804	\$885
DB 21-3	21	34 1/2	24	\$789	\$893	\$982
DB 24-3	24	34 1/2	24	\$831	\$941	\$1,035
DB 27-3	27	34 1/2	24	\$847	\$959	\$1,055
DB 30-3	30	34 1/2	24	\$857	\$971	\$1,069
DB 33-3	33	34 1/2	24	\$909	\$1,029	\$1,132
DB 36-3	36	34 1/2	24	\$963	\$1,090	\$1,199

### Base Blind Corner Cabinets



Item	Width	Height	Depth	A	B	C
BCB39	39	34 1/2	24	\$840	\$951	\$1,046
BCB42	42	34 1/2	24	\$901	\$1,020	\$1,122
BCB45	45	34 1/2	24	\$957	\$1,084	\$1,193

### Sink Base Cabinets



Item	Width	Height	Depth	A	B	C
SB30	30	34 1/2	24	\$692	\$784	\$863
SB33	33	34 1/2	24	\$736	\$834	\$918
SB36	36	34 1/2	24	\$779	\$882	\$971

### Angle Base Cabinets



Item	Width	Height	Depth	A	B	C
ASB 36	36	34 1/2	24	\$1,123	\$1,272	\$1,399
ASB 42	42	34 1/2	24	\$1,227	\$1,389	\$1,528

### Lazy Susan Base Cabinet



Item	Width	Height	Depth	A	B	C
LS33	33	34 1/2	24	\$1,064	\$1,205	\$1,326
LS36	36	34 1/2	24	\$1,145	\$1,297	\$1,427

*Lazy Susan Metal Rack sold separately, see accessories. Plywood shelves included.*

### Base Pull Out

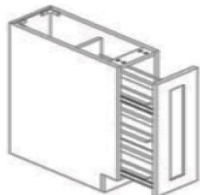

Item	Width	Height	Depth	A	B	C
BPO6	6	34 1/2	24	\$474	\$546	\$601
BPO9	9	34 1/2	24	\$548	\$621	\$683



**Base Wine Rack**



Item	Width	Height	Depth	A	B	C
BWR 6	6	34 1/2	24	\$321	\$364	\$400

**Base End Cabinet**



Item	Width	Height	Depth	A	B	C
BEC 9 R/L	9	34 1/2	24	\$343	\$388	\$427

## Utility Cabinet

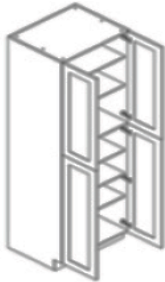

### Utility Cabinet 96" (Pullouts available)

Item	Width	Height	Depth	A	B	C
UC 1896	18	96	24	N/A	\$1,882	\$2,071
UC 2496	24	96	24	N/A	\$1,976	\$2,174
UC 3096	30	96	24	N/A	\$2,087	\$2,460

### Utility Cabinet 90" (Pullouts available)

Item	Width	Height	Depth	A	B	C
UC 1890	18	90	24	\$1,540	\$1,744	\$1,918
UC 2490	24	90	24	\$1,709	\$1,935	\$2,129
UC 3090	30	90	24	\$1,832	\$2,075	\$2,282

### Utility Cabinet 84" (Pullouts available)

Item	Width	Height	Depth	A	B	C
UC 1884	18	84	24	\$1,411	\$1,598	\$1,758
UC 2484	24	84	24	\$1,550	\$1,755	\$1,930
UC 3084	30	84	24	\$1,712	\$1,939	\$2,132

## Oven Cabinet

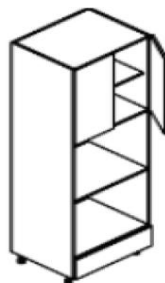

### Oven Cabinet 96"

Item	Width	Height	Depth	A	B	C
OC 3096	30	96	24	N/A	\$2,329	\$2,562

### Oven Cabinet 90"

Item	Width	Height	Depth	A	B	C
OC 3090	30	90	24	\$1,959	\$2,218	\$2,440

### Oven Cabinet 84"

Item	Width	Height	Depth	A	B	C
OC 3084	30	84	24	\$1,852	\$2,097	\$2,306

### Vanity Base

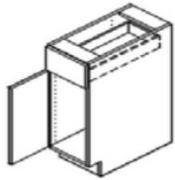

Item	Width	Height	Depth	A	B	C
VB-15	15	34 1/2	21	\$467	\$513	\$564
VB-18	18	34 1/2	21	\$511	\$562	\$618
VB-21	21	34 1/2	21	\$555	\$611	\$672

### Vanity Sink Base

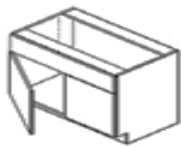

Item	Width	Height	Depth	A	B	C
VS-24	24	34 1/2	21	\$658	\$737	\$811
VS-30	30	34 1/2	21	\$692	\$784	\$863
VS-36	36	34 1/2	21	\$779	\$882	\$971

### Vanity Drwer Base Cabinet

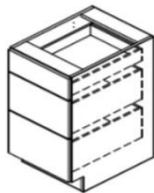

Item	Width	Height	Depth	A	B	C
VDB12-3	12	34 1/2	21	\$667	\$747	\$822
VDB15-3	15	34 1/2	21	\$699	\$783	\$861
VDB18-3	18	34 1/2	21	\$729	\$821	\$904

### Vanity Knee Drawer

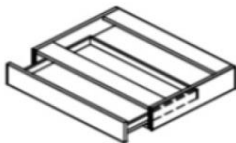

Item	Width	Height	Depth	A	B	C
VKD24	24	7	21	\$125	\$141	\$155
VKD30	30	7	21	\$135	\$155	\$170

### Wine Rack

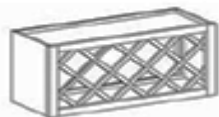

Item	Width	Height	Depth	A	B	C
WR 3612	36	12	12	\$447	\$506	\$557
WR 3615	36	15	12	\$465	\$527	\$580

### Wine Rack



Item	Width	Height	Depth	A	B	C
WR 3612	36	12	12	\$447	\$506	\$557
WR 3615	36	15	12	\$465	\$527	\$580

### Wall China Display



Item	Width	Height	Depth	A	B	C
WCD 3615	36	15	12	\$633	\$717	\$788

### Pull Outs



Item	Width	Height	Depth	A	B	C
PO 18	18	3	20	\$89	\$89	\$89
PO 21	21	3	20	\$89	\$89	\$89
PO 24	24	3	20	\$93	\$93	\$93
PO 27	27	3	20	\$98	\$98	\$98
PO 30	30	3	20	\$110	\$110	\$110
PO 36	36	3	20	\$122	\$122	\$122

*Full extension Slides Included in natural finish*

### Lazy Susan Inserts (Kidneys)

Item	Size	A	B	C
LS Round Metal 33	33	\$320	\$320	\$320
LS Round Metal 36	36	\$320	\$320	\$320

### Self Close Hinges

Item	A	B	C
Hinges	\$6	\$6	\$6

**Fillers 3"**



Item	Width	Height	Depth	A	B	C
F330	3	30	3/4	\$57	\$65	\$72
F336	3	36	3/4	\$69	\$78	\$85
F342	3	42	3/4	N/A	\$91	\$101
F396	3	96	3/4	\$183	\$207	\$228

**Filler's 6"**



Item	Width	Height	Depth	A	B	C
F630	6	30	3/4	\$130	\$165	\$181
F636	6	36	3/4	\$165	\$155	\$171
F642	6	42	3/4	N/A	\$181	\$200
F696	6	96	3/4	N/A	\$414	\$456

**Fluttered Fillers 3"**



Item	Width	Height	Depth	A	B	C
FF330	3	30	3/4	\$86	\$100	\$110
FF336	3	36	3/4	\$86	\$100	\$110
FF342	3	42	3/4	\$106	\$116	\$128
FF384	3	84	3/4	\$230	\$254	\$279
FF390	3	90	3/4	\$247	\$272	\$299
FF396	3	96	3/4	N/A	\$290	\$319

**Fluttered Fillers 6"**



Item	Width	Height	Depth	A	B	C
FF630	3	30	3/4	\$130	\$171	\$188
FF636	3	36	3/4	\$181	\$199	\$219
FF642	3	42	3/4	\$213	\$232	\$255
FF684	3	84	3/4	\$397	\$420	\$462
FF690	3	90	3/4	\$427	\$450	\$495
FF696	3	96	3/4	N/A	\$484	\$532

### Base End Panel



Item	Width	Height	Depth	A	B	C
BEP	3/4	34 1/2	23 3/4	\$130	\$147	\$162

### Refridgerator End Panel



Item	Width	Height	Depth	A	B	C
REP 3696	36	96	3/4	\$410	\$410	\$451

### Finish Back Panel



Item	Width	Height	Depth	A	B	C
FBP4896	96	48	1/8	\$240	\$272	\$299

### Toe Kick



Item	Width	Height	Depth	A	B	C
TK 96	96	4 1/2	1/8	\$52	\$59	\$65

### Base Molding

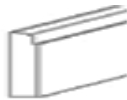

Item	Width	Height	Depth	A	B	C
BM 96	96	4 1/2	3/4	\$170	\$192	\$211

### Scribe Molding



Item	Width	Height	Depth	A	B	C
SM 96	96	3/4	1/4	\$56	\$63	\$69

### Outside Corner Molding



Item	Width	Height	Depth	A	B	C
OCM 96	96	3/4	1/4	\$80	\$90	\$99

### Classic Crown Molding



Item	Width	Height	Depth	A	B	C
CCM	96	3 3/4	3/4	\$190	\$200	\$220

*CCM not available in Toscana / Modena / Hampton / Madison*

### Classic Cove Molding



Item	Width	Height	Depth	A	B	C
CVC	96	3 3/4	3/4	N/A	N/A	\$220

### Angle Crown Molding



Item	Width	Height	Depth	A	B	C
ACM	96	3 3/4	3/4	N/A	\$276	\$304

*ACM not available in Prestige / Lexington / Camden / Rockport / Boardwalk*

### Small Dentil Insert



Item	Width	Height	Depth	A	B	C
SDI	96	1	1/2	\$62	\$65	\$72

*SDI not available in Toscana / Modena / Hampton / Madison*

### Ribbon Twist Insert



Item	Width	Height	Depth	A	B	C
RTI	96	1	1/2	\$65	\$68	\$75

*RTI not available in Toscana / Modena / Hampton / Madison*

### Light Moulding Classic



Item	Width	Height	Depth	A	B	C
LMC	96	2	3/4	\$129	\$142	\$156

### Light Moulding Shaker

Item	Width	Height	Depth	A	B	C
LMS	96	2	3/4	N/A	\$189	\$189

*LMS not available in Prestige, Rockport, Lexington, Camden*

### Valance



Item	Width	Height	Depth	A	B	C
VS36	36	5 1/2	3/4	\$158	\$179	\$197
VS48	48	5 1/2	3/4	\$178	\$201	\$221
VS60	60	5 1/2	3/4	\$197	\$223	\$245

## Corbel



Item	Width	Height	Depth	A	B	C
CRBL	5	10	5 3/4	\$571	\$647	N/A

CRBL not available in Toscana / Modena / Hampton / Madison

## Corbel Shaker

Item	Width	Height	Depth	A	B	C
CRBLS	5	10	5 3/4	N/A	\$647	\$745

CRBLS not available in Toscana / Modena / Hampton / Madison

## Spindel Leg



Item	Width	Height	Depth	A	B	C
SP 4	4 3/4	42	4 3/4	\$623	\$706	\$777

SP4 not available in Toscana / Modena / Hampton / Madison

## Flute Square Post

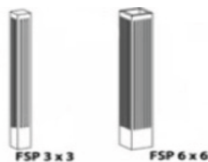

Item	Width	Height	Depth	A	B	C
FSP 3X3	3	34 1/2	3	\$261	\$295	\$325
FSP 6X6	6	34 1/2	6	\$496	\$562	\$618

FSP not available in Toscana / Modena / Hampton / Madison

## Waste Bin



SINGLE WASTE BIN



DOUBLE WASTE BINS

Item	Width	Height	Depth	A	B	C
WBS	17 3/4	10 1/4	20 1/2	\$157		
WBD	21	16 1/2	20 1/2	\$211		

\*WBS: Single waste bin, fits B15 and bigger cabinets

\*WBD: Double waste bin, fits B21 and bigger cabinets



### Base Decorative Panel



Item	Width	Height	Depth	A	B	C
BDP2430	23 7/8	29 7/8	3/4	\$346	\$392	\$432

### Wall Decorative Panel



Item	Width	Height	Depth	A	B	C
WDP 1230	11 7/8	29 7/8	3/4	\$206	\$233	\$256
WDP 1236	11 7/8	35 7/8	3/4	\$233	\$264	\$290
WDP 1242	11 7/8	41 7/8	3/4	N/A	\$295	\$325

### Glass Doors



Item	Width	Height	Depth	A	B	C
GD 1230	11 7/8	29 7/8	3/4	\$175	\$198	\$218
GD 1530	14 7/8	29 7/8	3/4	\$200	\$227	\$250
GD 1830	17 7/8	29 7/8	3/4	\$229	\$259	\$285
GD 1236	11 7/8	35 7/8	3/4	\$202	\$229	\$252
GD 1536	14 7/8	35 7/8	3/4	\$228	\$258	\$284
GD 1836	17 7/8	35 7/8	3/4	\$251	\$284	\$313
GD 1242	11 7/8	41 7/8	3/4	N/A	\$277	\$305
GD 1542	14 7/8	41 7/8	3/4	N/A	\$290	\$319
GD 1842	17 7/8	41 7/8	3/4	N/A	\$309	\$340

\*Mullions are not available in Hampton, Madison, and Broadwalk

### Glass Doors Angle Wall Cabinets



Item	Width	Height	Depth	A	B	C
GD AWC 243012	16	29 7/8	3/4	\$200	\$227	\$250
GD AWC 243612	16	35 7/8	3/4	\$228	\$258	\$284
GD AWC 244212	16	41 7/8	3/4	N/A	\$290	\$319
GD AWC 273615	16-5/8	35 7/8	3/4	\$246	\$279	\$306
GD AWC 274215	16-5/8	41 7/8	3/4	\$260	\$299	\$329

\*Mullions are not available in Hampton, Madison, and Broadwalk