

FER·MA[®]

FERMAWOOD CABINETRY

Presents

Signature
Impressions

MADE IN USA

Distributed by FERMAWOOD CABINETRY



www.fermawoodcabinetry.com

sales@fermawoodcabinetry.com

83 Mayfield Ave., Edison, New Jersey 08837

Toll Free: 1-877-FERMA-28

Toll Free FAX: 1-888-900-0686

| Tel: 732-225 5200 | Fax: 732-225 5290

INDEX OF PAGES

- 1. INDEX
- 2. CABINET CONSTRUCTION
- 3. CABINET CONSTRUCTION: TEXTURED MATTE FINISH COLLECTION
- 4. FINISHES: TEXTURED MATTE FINISH COLLECTION
- 5-11. TEXTURED MATTE FINISH GALLERY
- 12. CABINET CONSTRUCTION: ACRYLIC HIGH GLOSS FINISH COLLECTION
- 13. FINISHES: ACRYLIC HIGH GLOSS FINISH COLLECTION
- 14-19. ACRYLIC HIGH GLOSS FINISH GALLERY
- 20-21. ACCESSORIES
- 22. 10' X 10' KITCHEN SAMPLE
- 23. ISNLAND KITCHEN SAMPLE
- 24-25 CARE AND MAINTENENCE
- 26-27. COVERAGE OF WARRANTY

MADE IN USA

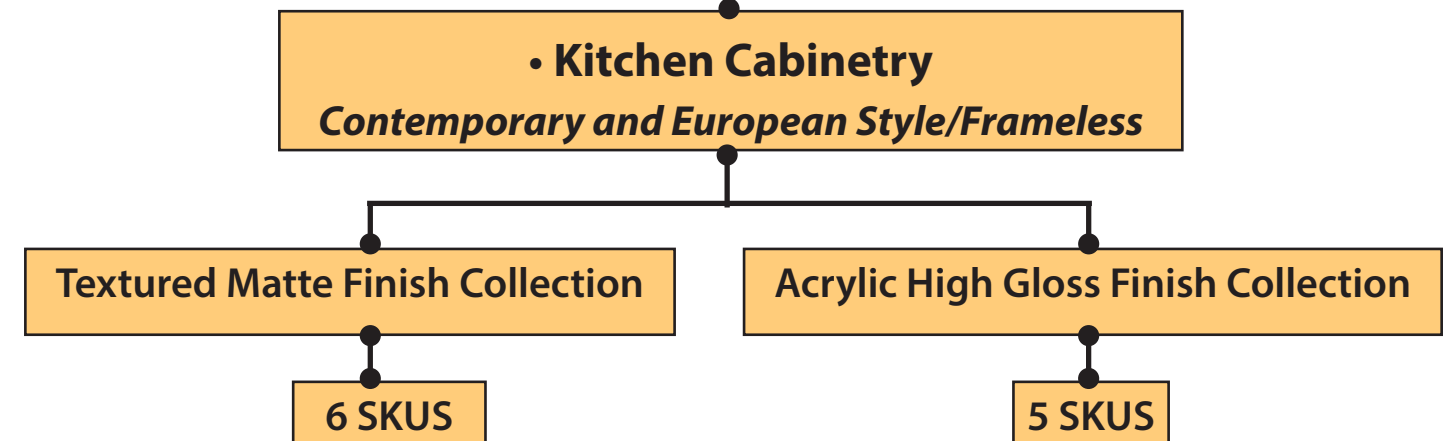

LACEY ACT
 Hardwood
 for cabinetry is
 LACEY ACT
 Compliant.



www.fermawoodcabinetry.com
sales@fermawoodcabinetry.com
 83 Mayfield Ave., Edison, New Jersey 08837
 Toll Free: 1-877-FERMA-28
 Toll Free FAX: 1-888-900-0686
 | Tel: 732-225 5200 | Fax: 732-225 5290

CABINET CONSTRUCTION

**Textured Matte Finish
Acrylic High Gloss
Finish
Door & Drawer Fronts**

- 1 Backing of the Cabinet:**
Base cabinet 11/16" (approximately 3/4") plywood.
Wall cabinet: 1/4" plywood with 3/4" hanging rail.
- 2 Side & Top and Bottom Panel:**
11/16" (approximately 3/4") plywood side, bottom and top for wall cabinets.
11/16" (approximately 3/4") plywood side, bottom for base cabinet.
Color: white inside and outside for standard cabinets. The side panel color can be upgraded to the same material used for door and drawer fronts.

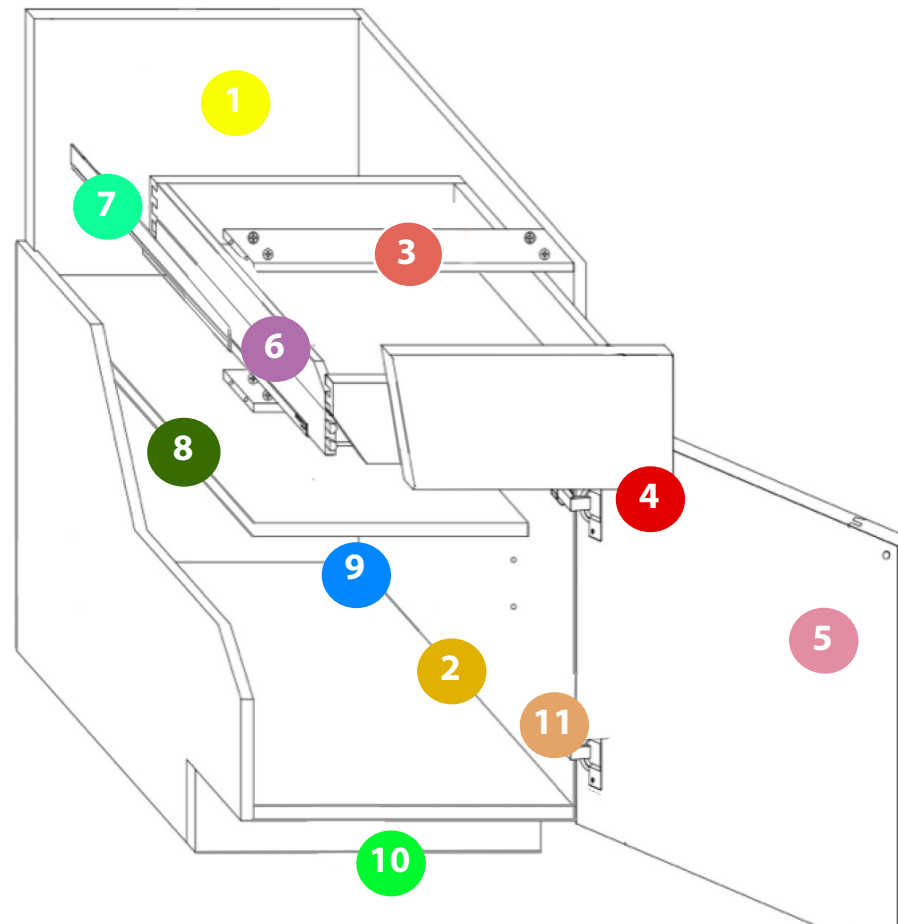

- 3 11/16" Bridge:**
The bridge is for added stability, and strength, which is connected to the left and right side panels. It is fastened with dowels and camlocks.
- 4 Cabinet Door and Drawer Front:**
Slab door style:
A. Textured matte finish style: Thermal fused laminated surface over 3/4" furniture core board.
B. Acrylic high gloss finish style: styrene colored layer, which is permanently fused with a clear ultra high gloss acrylic on 3/4" MDF core board.
- 5 The back of the door has the same color and graining style as the cabinet fronts.**
- 6 Drawer Construction:**
5/8" thick solid wood drawer sides, plywood bottom 3/8" thickness. Drawers are soft closing and dovetail joint construction.
- 7 Drawer Runner:**
Undermount soft close full extension.
- 8 Adjustable Shelves:**
11/16" (approximately 3/4") plywood shelf with a thermal fused Laminated Surface, edge banding front. 18" depth for base cabinet, and 10" depth for wall cabinet.
- 9 Interior Back Bottom:**
Corner dust guards on door base cabinets and wall cabinets.
- 10 Toe Kick.**
3/4" thick with matching color.
- 11 Hinges.**
6 way adjustable soft closing, except on certain cabinets such as lazy Susan cabinets, and diagonal corners.

NOTES:

Assembly Construction: Dowels with glue, secured with screws.

Edge Banding: Coordinating on exposed front edges.



CABINET CONSTRUCTION

www.fermawoodcabinetry.com

sales@fermawoodcabinetry.com

83 Mayfield Ave., Edison, New Jersey 08837

Toll Free: 1-877-FERMA-28

Toll Free FAX: 1-888-900-0686

| Tel: 732-225 5200 | Fax: 732-225 5290

1. DOORS AND DRAWERS FRONTS:

Thermo fused laminated surface over 3/4" furniture core board, with matching edge banding.

Color: Matte wood tone on door and drawer fronts.

2. STYLE:

Slab doors and drawer fronts over frameless style cabinetry.

3. DOORS AND DRAWER FRONT DESIGN:

European contemporary with vertical grain pattern design. There is no directional book matching across face of cabinetry. The back of door has the same color and graining style as the cabinet fronts. Optional 8 ft. matching toe kick has horizontal directional graining or color.

4. DRAWER CONSTRUCTION:

Solid wood drawer sides, plywood bottom. Drawers are undermount soft closing and full extension. Dovetail drawer construction.

5. DOOR & DRAWER FRONT FINISH:

The thermo fused laminated surface features include: heat, moisture, stain, abrasion, and peel resistant properties.

6. CABINET HINGES:

EUROPEAN HINGES: 6 way adjustable soft closing, except on certain cabinets such as: lazy Susan cabinet, and diagonal corners. Heavy duty upgraded piston hinges for horizontal (up) door.

7. OPTIONAL GLASS DOORS:

Available in aluminum or wood framed door styles. Frosted or clear glass available.

8. INTERIOR DUST CORNET GUARDS:

Interior back bottom corner dust guards on door base cabinets and wall cabinets.

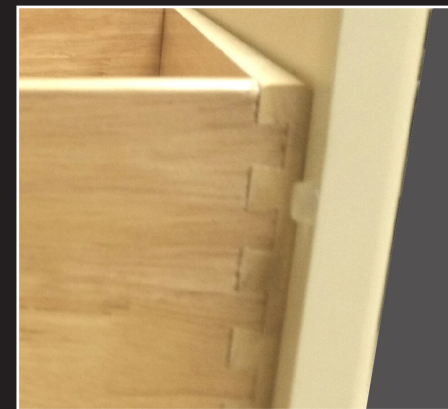

4. Drawer System: Dovetail Joints.



6. Cabinet Hinges: European Hinges



7. Optional Glass Doors: Aluminum Frame



6. Cabinet Hinges: Heavy Duty Piston Hinges For horizontal (Up) Doors.



7. Optional Glass Doors: Wood Frame



8. Interior Corner Dust Guards



TEXTURED MATTE FINISHED COLLECTION

www.fermawoodcabinetry.com

sales@fermawoodcabinetry.com

83 Mayfield Ave., Edison, New Jersey 08837

Toll Free: 1-877-FERMA-28

Toll Free FAX: 1-888-900-0686

| Tel: 732-225 5200 | Fax: 732-225 5290

TEXTURED MATTE FINISH COLLECTION

Style Name	Model #	Price Group
SEASIDE	SI-SS	A
DAYTONA	SI-DT	A
MANHATTAN	SI-MH	A
VENTURA	SI-VT	A
POMPANO	SI-PM	A
HOLLYWOOD	SI-HW	A



SEASIDE
MODEL # SI-SS
PAGE 6



DAYTONA
MODEL # SI-DT
PAGE 7



MANHATTAN
MODEL # SI-MH
PAGE 8



VENTURA
MODEL # SI-VT
PAGE 9

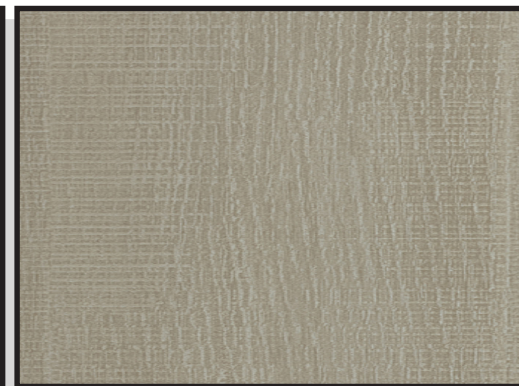

POMPANO
MODEL # SI-PM
PAGE 10



HOLLYWOOD
MODEL # SI-HW
PAGE 11

All pictures and color references in this catalog are computer rendered . Please see actual sample for color likeness, for each kitchen model



TEXTURED MATTE FINISHES

www.fermawoodcabinetry.com
sales@fermawoodcabinetry.com
 83 Mayfield Ave., Edison, New Jersey 08837
Toll Free: 1-877-FERMA-28
Toll Free FAX: 1-888-900-0686
 | Tel: 732-225 5200 | Fax: 732-225 5290



TEXTURED MATTE FINISH COLLECTION

www.ferwoodcabinetry.com
sales@ferwoodcabinetry.com
83 Mayfield Ave., Edison, New Jersey 08837
Toll Free: 1-877-FERMA-28
Toll Free FAX: 1-888-900-0686
| Tel: 732-225 5200 | Fax: 732-225 5290



TEXTURED MATTE FINISH

SEASIDE
TEXTURED MATTE FINISH
MODEL# SI-SS



Aluminum Accents shown on drawer fronts are not available



TEXTURED MATTE FINISH

DAYTONA
TEXTURED MATTE FINISH
MODEL# SI-DT



TEXTURED MATTE FINISH

MANHATTAN
TEXTURED MATTE FINISH
MODEL# SI-MH



Aluminum Accents shown on drawer fronts are not available



TEXTURED MATTE FINISH

VENTURA
TEXTURED MATTE FINISH
MODEL# SI-VT



TEXTURED MATTE FINISH

POMPANO
TEXTURED MATTE FINISH
MODEL# SI-PM



TEXTURED MATTE FINISH

HOLLYWOOD
TEXTURED MATTE FINISH
MODEL# SI-HW

1. DOORS AND DRAWERS FRONTS:

Styrene colored layer, which is permanently fused with a clear ultra high gloss acrylic top layer, and 3/4" MDF core board with matching edge banding.

2. STYLE:

Slab doors and drawer fronts over frameless style cabinetry.

3. DOORS AND DRAWER FRONT DESIGN:

FERMAWOOD high gloss door & drawer fronts are the superior choice for creating a stunning, modern kitchen. Delivering a superior appearance. Available in 5 color selections.

4. DRAWER CONSTRUCTION:

Solid wood drawer sides, plywood bottom. Drawers are undermount soft closing and full extension. Dovetail drawer construction.

5. DOOR & DRAWER FRONT FINISH:

FERMAWOOD offers a Luxurious ripple-free finished panels for all of our high gloss doors, and drawer fronts. It can be cleaned and maintained using warm soapy water, and does not require the use of harsh or volatile chemicals. The finish is protected during manufacture and installation by a removable clear peel coat. These panels have a repairable surface that won't chip, crack or delaminate. The panel surface hardens more, becomes more scratch resistant over the first few days after removal of the protective layer.

6. CABINET HINGES: EUROPEAN HINGES:

6 way adjustable soft closing, except on certain cabinets such as: lazy Susan cabinet, and diagonal corners. Heavy duty upgraded piston hinges for horizontal (up) door.

7. OPTIONAL GLASS DOORS:

Available in aluminum or wood framed door styles. Frosted or clear glass available.

8. INTERIOR DUST CORNET GUARDS:

Interior back bottom corner dust guards on door base cabinets and wall cabinets.

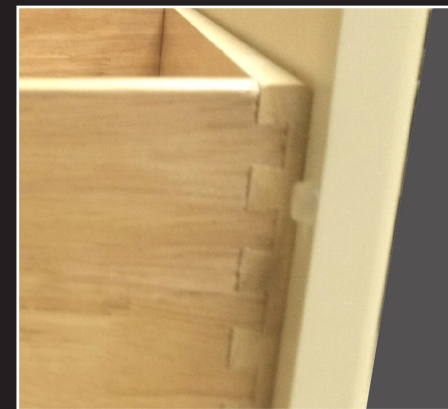

4. Drawer System: Dovetail Joints.



6. Cabinet Hinges: European Hinges



7. Optional Glass Doors: Aluminum Frame



6. Cabinet Hinges: Heavy duty piston hinges for horizontal (up) doors.



7. Optional Glass Doors: Wood Frame

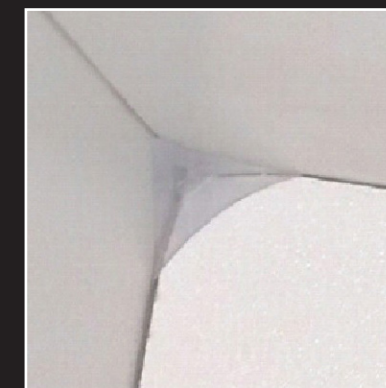

8. Interior Corner Dust Guards



ACRYLIC HIGH GLOSS FINISH COLLECTION

www.fermawoodcabinetry.com

sales@fermawoodcabinetry.com

83 Mayfield Ave., Edison, New Jersey 08837

Toll Free: 1-877-FERMA-28

Toll Free FAX: 1-888-900-0686

| Tel: 732-225 5200 | Fax: 732-225 5290

ACRYLIC HIGH GLOSS FINISH COLLECTION

Style Name	Model #	Price Group
ZUMA	SI-ZM	B
SUMMER POINT	SI-SP	B
BELMAR	SI-BM	B
MARGATE	SI-MG	B
ROCKAWAY	SI-RK	B

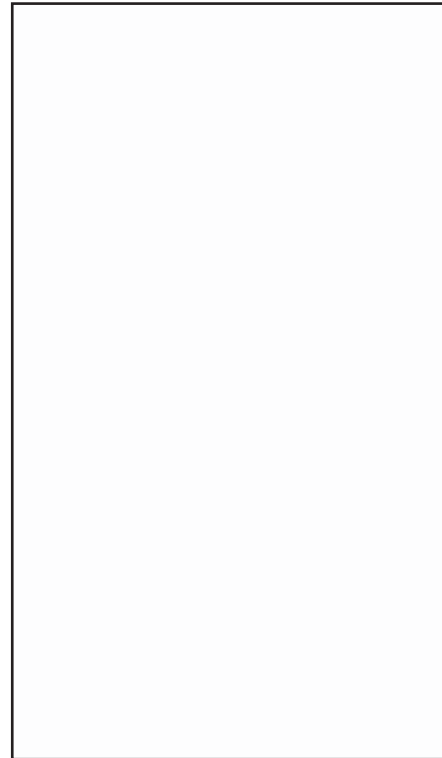

ZUMA
MODEL # SI-ZM
PAGE 15

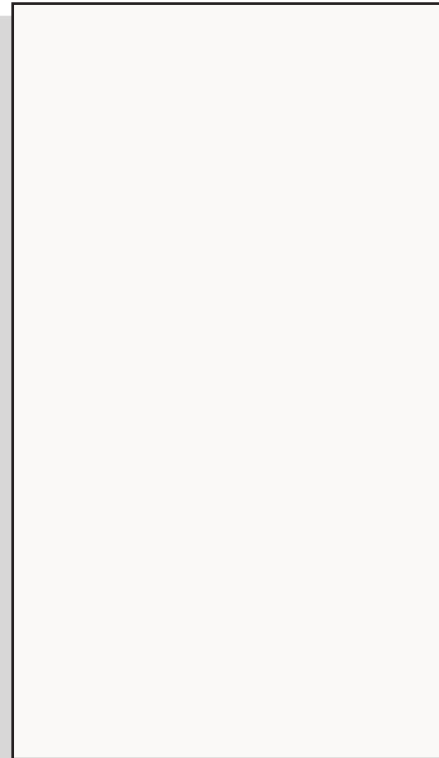

SUMMER POINT
MODEL # SI-SP
PAGE 16



BELMAR
MODEL # SI-BM
PAGE 17



MARGATE
MODEL # SI-MG
PAGE 18



ROCKAWAY
MODEL # SI-RK
PAGE 19

All pictures and color references in this catalog are computer rendered . Please see actual sample for color likeness, for each kitchen model



ACRYLIC HIGH GLOSS FINISHES

www.fermawoodcabinetry.com
sales@fermawoodcabinetry.com
 83 Mayfield Ave., Edison, New Jersey 08837
Toll Free: 1-877-FERMA-28
Toll Free FAX: 1-888-900-0686
 | Tel: 732-225 5200 | Fax: 732-225 5290



ZUMA



SUMMER POINT



MARGATE



BELMAR



ACRYLIC HIGH GLOSS COLLECTION

www.fermawoodcabinetry.com

sales@fermawoodcabinetry.com

83 Mayfield Ave., Edison, New Jersey 08837

Toll Free: 1-877-FERMA-28

Toll Free FAX: 1-888-900-0686

| Tel: 732-225 5200 | Fax: 732-225 5290



ACRYLIC HIGH GLOSS FINISH

ZUMA
ACRYLIC HIGH GLOSS FINISH
MODEL# SI-ZM



ACRYLIC HIGH GLOSS FINISH

SUMMER POINT
ACRYLIC HIGH GLOSS FINISH
MODEL# SI-SP



ACRYLIC HIGH GLOSS FINISH

BELMAR
ACRYLIC HIGH GLOSS FINISH
MODEL# SI-BM



ACRYLIC HIGH GLOSS FINISH

MARGATE
ACRYLIC HIGH GLOSS FINISH
MODEL# SI-MG



ACRYLIC HIGH GLOSS FINISH

ROCKAWAY
ACRYLIC HIGH GLOSS FINISH
MODEL# SI-RK

Chrome Metal Susan for Base Lazy Susan Cabinet

Item# LS3309 - For 9" Bi-Fold Door
 Item # LS3612 For 12" Bi-Fold Door
 24" Deep
 34 1/2" Tall



Roll Out Shelf

Under mount runner
 20" Deep X 3 1/4" Tall - consult
 specification pages for many widths
 available.

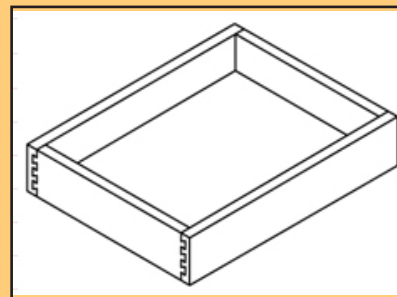

Aluminum Drawer Pull

Available for base cabinets only.

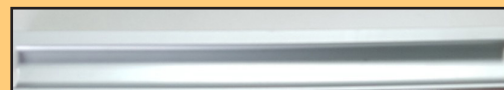

Toe Kick: Matching cabinet face material

Item# TK8
 2 Short Edge Finished
 4 1/2" Wide
 3/4" Thick
 96" Long

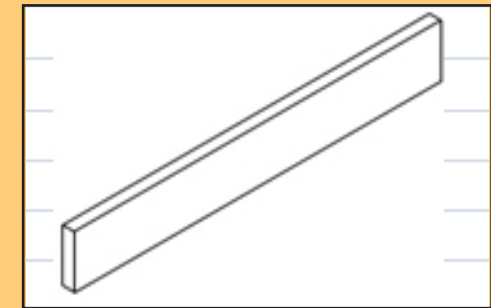

Toe Kick: Aluminum Appearance

Item# ATK8
 4 1/2" Wide 96" Long

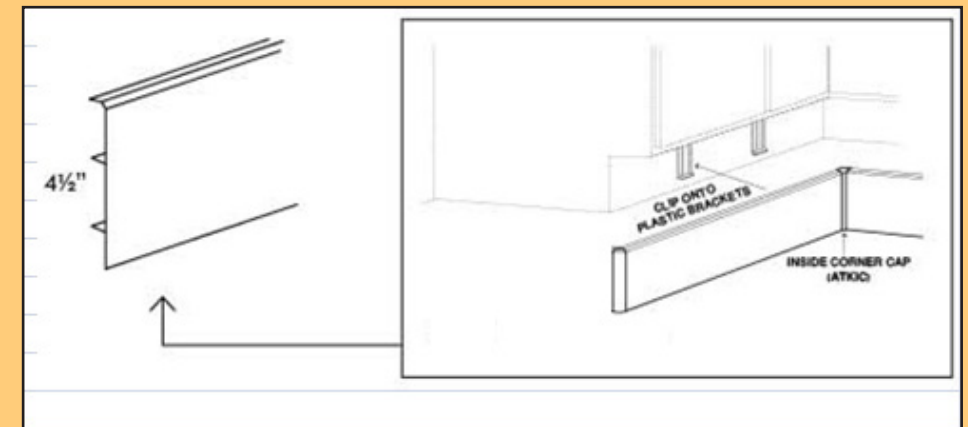

ACCESSORIES

www.ferrowoodcabinetry.com
sales@ferrowoodcabinetry.com
 83 Mayfield Ave., Edison, New Jersey 08837
 Toll Free: 1-877-FERMA-28
 Toll Free FAX: 1-888-900-0686
 | Tel: 732-225 5200 | Fax: 732-225 5290

Pull out Waste Basket Cabinet

Item# TC-18
2 Bucket attached on pull-out shelf
- Pull-Out, Chrome Finish
- 14 3/4" W X 22"D X 19 1/4" H
Includes Two White Containers.



Pull out Base Organizer

Item# B09FD*
9" pull-out cabinet
Wood Base Organizer:
6" W X 23"D X 27 3/8" H
Adj. Shelves
Box:
24"Deep, 34 1/2" Tall



Utility Cabinet With PULL-OUT DOOR

1 Pull-Out Door
Chrome Metal Shelves system:
Available for 12" or 18" wide Utility Cabinets.
Includes: 2 Adj. Shelves for 96" and 90" height cabinet, or 1 Adj. shelf for 84" height cabinet.



Double - Tier blind corner cabinet organizer

Item# 5372-45-GR L/R
Pivots and slides on a mounted telescopic post system.
Finish: Grey and Chrome
25" Tall



ACCESSORIES

www.fermawoodcabinetry.com

sales@fermawoodcabinetry.com

83 Mayfield Ave., Edison, New Jersey 08837

Toll Free: 1-877-FERMA-28

Toll Free FAX: 1-888-900-0686

| Tel: 732-225 5200 | Fax: 732-225 5290

10' X 10 KITCHEN SAMPLE

GROUP A	LIST PRICE
GROUP B	\$8,437.34
	\$10,699.74

ITEM#	QTY	GROUP A	GROUP B
W1230L	1	\$354.20	\$416.00
W2430	1	\$528.00	\$671.67
W2430	1	\$528.00	\$671.67
WDC2430R	1	\$498.67	\$823.33
W1230L	1	\$354.20	\$416.00
W3012	1	\$381.33	\$472.33
W1830R	1	\$436.33	\$511.33
W3612	1	\$430.22	\$533.00
B12L	1	\$633.33	\$883.33
SB36	1	\$1,033.33	\$1,445.83
B12R	1	\$633.33	\$883.33
LSB36R	1	\$977.53	\$1,227.12
-547232CR	1	\$749.80	\$749.80
B18R	1	\$734.07	\$830.00
TK8	1	\$165.00	\$165.00

	LISTING PRICE
	\$8,437.34 \$10,699.74

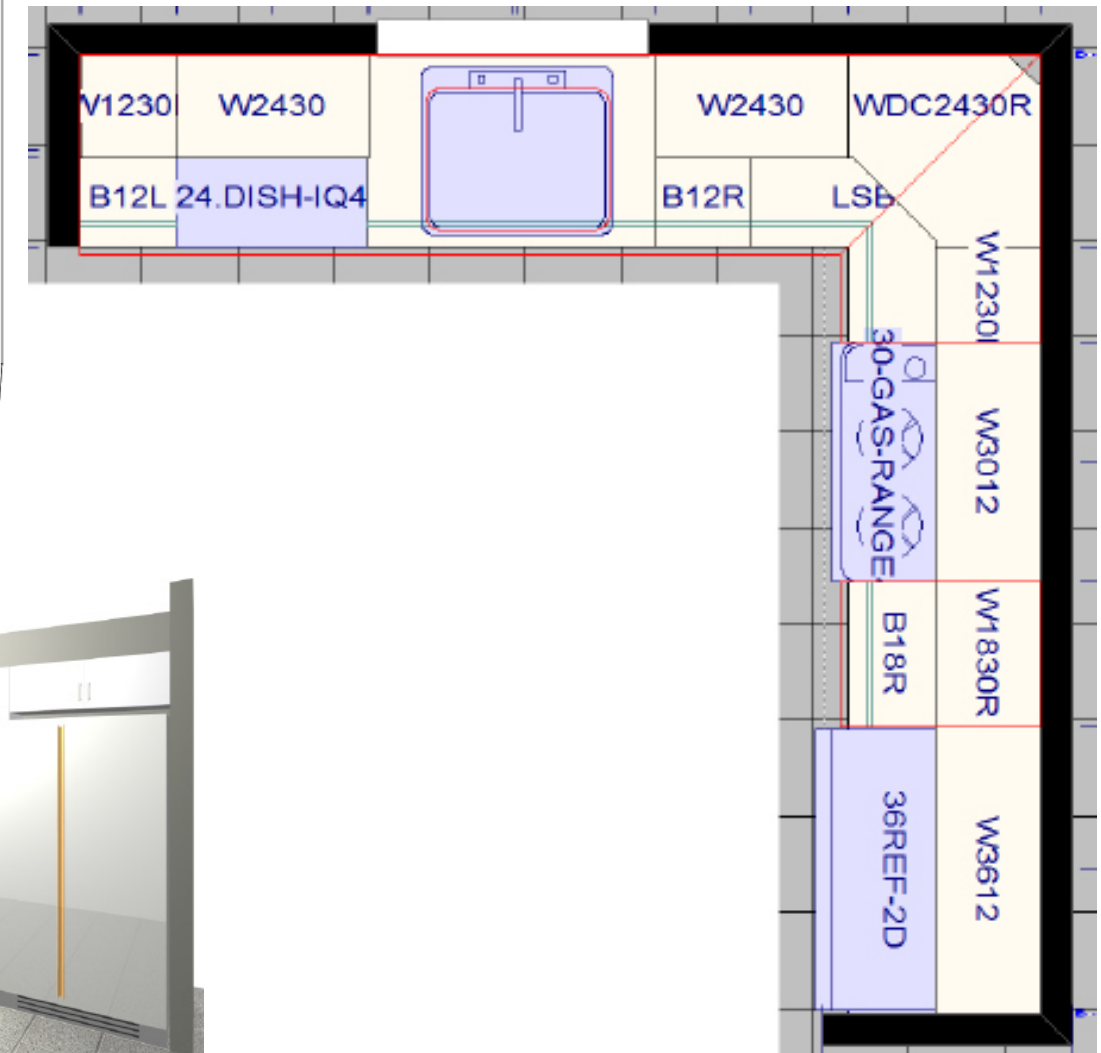
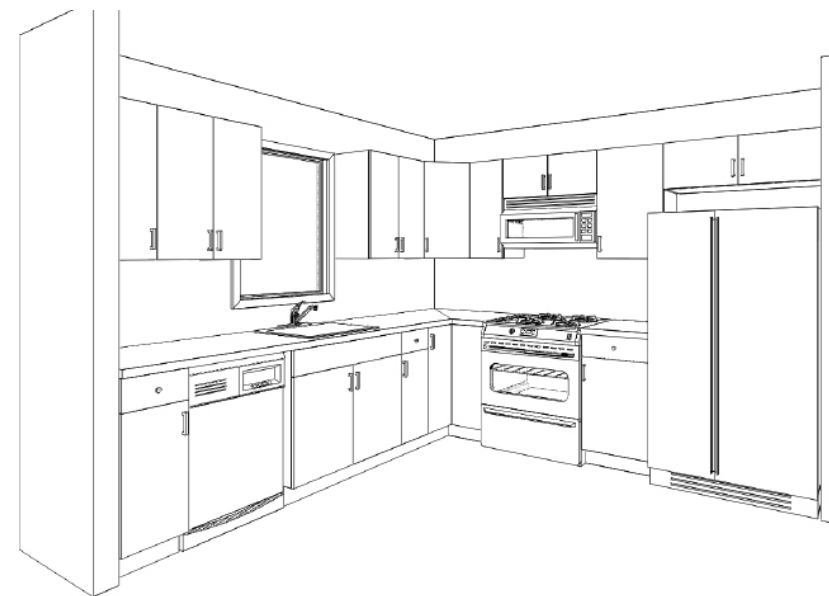

10' X 10' KITCHEN SAMPLE

www.ferwoodcabinetry.com
sales@ferwoodcabinetry.com
 83 Mayfield Ave., Edison, New Jersey 08837
Toll Free: 1-877-FERMA-28
Toll Free FAX: 1-888-900-0686
 | Tel: 732-225 5200 | Fax: 732-225 5290

ISLAND KITCHEN SAMPLE

36" ISLAND KITCHEN SAMPLE

	LIST PRICE
GROUP A	\$1,755.00
GROUP B	\$2,261.08

Countertop and handles not included.

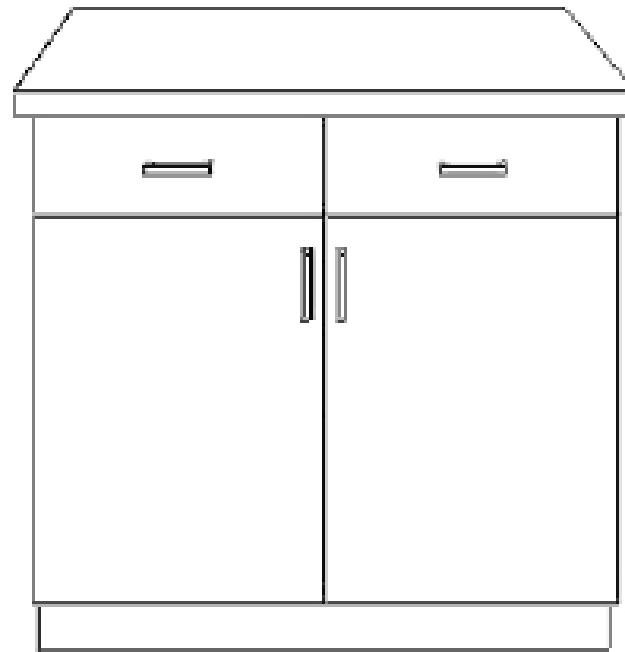

ITEM#	QTY	GROUP A	GROUP B
B36	1	\$1200.00	\$1608.33
PLY-3/4-1	1	\$390.00	\$487.75
TK-8	1	\$165.00	\$165.00
		LISTING PRICE	
		\$1,755.00	\$2,261.08

66" ISLAND KITCHEN SAMPLE

	LIST PRICE
GROUP A	\$3,622.46
GROUP B	\$4,872.36

Countertop and handles not included.

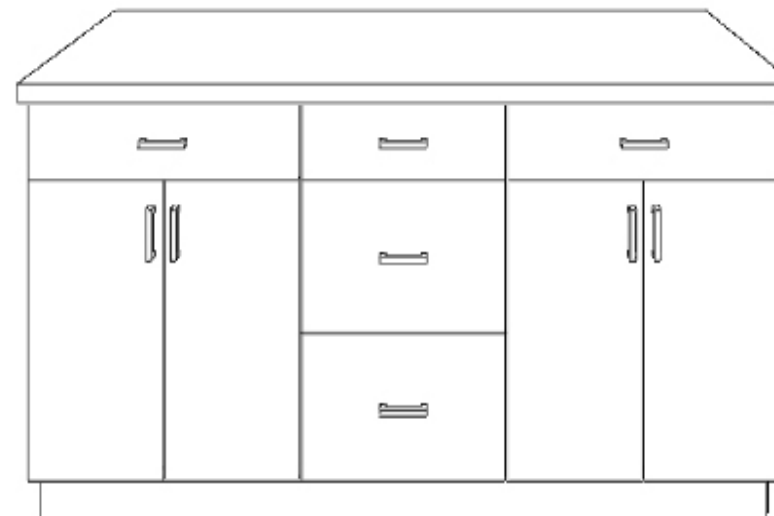

ITEM#	QTY	GROUP A	GROUP B
B24	1	\$833.33	\$1166.67
DB18-3	1	\$1075.80	\$1480.27
B24	1	\$833.33	\$1166.67
PLY-3/4-1	1	\$715.00	\$893.75
TK-8	1	\$165.00	\$165.00
		LISTING PRICE	
		\$3,622.46	\$4,872.36



ISLAND KITCHEN SAMPLE

www.fermawoodcabinetry.com

sales@fermawoodcabinetry.com

83 Mayfield Ave., Edison, New Jersey 08837

Toll Free: 1-877-FERMA-28

Toll Free FAX: 1-888-900-0686

| Tel: 732-225 5200 | Fax: 732-225 5290

Effective 01/01/2016

ACRYLIC HIGH GLOSS COLLECTION

Cleaning Do's and Don'ts

The door and drawer fronts can be cleaned simply using a wet microfiber cloth or chamois with non-abrasive soap. (Mild dish detergent)

Do Use	Don't Use
✓ Clean wet microfibre cloth	✗ Paper towel
✓ Clean wet chamois	✗ Dry wipe at any time
✓ Novus No. 1 polish used often	✗ Brushes, scourers or scrapers
✓ Non abrasive soap and detergent	✗ Abrasive cleaners
✓ Warm water	✗ Thinners or Methylated Spirits

Scratch Repair

The surface becomes more scratch resistant over the first few days after the removal of the protective film. This process can be accelerated by lightly polishing the surface immediately after the masking film is re-moved using Novus® No. 1 or Plexus® plastic polishes with a clean microfiber cloth.

General Cleaning

Apply Novus® No. 1 Plastic Polish, Plexus® Plastic Polish or warm soapy water and wipe using a clean microfiber, soft cloth or damp chamois.

Removing Marks and Light Scratches

Apply Novus® No. 2 or a good quality liquid polish (e.g. 3M™ Finesse-It™ II, Kitten® Polishing Wax) and using a damp, clean microfiber or soft cloth, polish in a circular pattern. Then remove polish using General Cleaning procedure above.

Removing Heavier Scratches

Apply Novus® No. 3 or a good quality fine compound polish (e.g. 3M™ Perfect-It™ III) and using

a damp, clean microfiber or soft cloth, polish in back and forth motion at right angles to visible scratches. Then use Removing Marks and Light Scratches procedure, then General Cleaning procedure above. Ensure all polish residues are removed completely from the door or drawer surface. Low speed electric buffing can also be used to repair marks and scratches.

Interior and exterior surfaces

FERMAWOOD Cabinetry is designed to be low maintenance, for interior use only. Please follow these guidelines to maintain the appearance and beauty of our kitchen cabinetry.

- Avoid prolonged exposure to direct sunlight. •

Self cleaning appliances generate intense heat during a cleaning cycle. FERMAWOOD recommends the removal of doors and/or drawers from cabinets adjacent to or directly above an appliance during a cleaning cycle. This will help prevent possible damage to the finish or surface of these cabinets.

Avoid prolonged exposure to direct sunlight. Cabinetry can discolor by either lightening or darkening due to light exposure, natural from sunlight or artificial. Age, lighting, and exposure to the elements all have an expected and natural effect on cabinetry and are not considered to be manufacturer's defects.

Clean with a mild household detergent and non-abrasive lint free cloth. Most com-mon stains should be easily removed. (NOTE: Avoid using any corrosive chemicals such as bathroom or toilet cleaners which may permanently damage the surface) After cleaning, wipe off all residue with clean warm water. • Avoid contact with sharp or abrasive objects. The thermos fused laminated surface is designed to be resistant to minor scratches but can be damaged if excessive force is applied to the surface. Always cover the surface first prior to placing any sharp or abrasive objects on the surface. • Avoid con-tact with any hot surfaces. TFL is resistant to heat but any prolonged exposure to heat may cause perma-nent damage to the surface. Always use a protective pad to minimize the exposure to heat damage.

- ♦ Because wood products shrink and expand with changes in humidity, some control of interior temperature and humidity, where cabinetry is installed, should be in place to minimize the changes

Average temperature: 55F to 85F / Average relative humidity: 35% - 55%

Continued on next page



CARE AND MAINTENANCE

www.fermawoodcabinetry.com

sales@fermawoodcabinetry.com

83 Mayfield Ave., Edison, New Jersey 08837

Toll Free: 1-877-FERMA-28

Toll Free FAX: 1-888-900-0686

| Tel: 732-225 5200 | Fax: 732-225 5290

Continued

CLEANING PRODUCTS TO AVOID

The following cleaning products are to be avoided as damage may occur:

- ◆ Harsh detergents, strong soaps, abrasive cleaning products such as tub and sink cleansers, scouring powder, steel wool or self polishing waxes, scouring pads, steel wool, or rough sides of sponges – it may seem obvious to avoid using these products, but once in a while you may consider using them to remove stubborn stains. More than likely, they will damage your cabinetry surface.
- ◆ Sponges or dish cloths. They may contain particles that could scratch your cabinets, or they may contain food and oil residue or remnants of harsh cleaning solutions.
- ◆ Solvent-based or petroleum-based products such as mineral spirits, nail-polish removers or paint thinners, Ammonia or cleaning products that include ammonia., Bleach or cleaning

SPLATTERS AND SPILLS

Clean spills and splatters immediately. Prolonged exposure to spills, including food, water or other liquids, or to oil and grease splatters, can cause permanent discoloration or damage to your cabinet's finish. Also avoid hanging dish towels in contact with cabinet surface. Towels can contain moisture, grease, or other that may harm the cabinetry.

TEXTURED MATTE FINISH COLLECTION

Interior and exterior surfaces

FERMAWOOD Cabinetry is designed to be low maintenance, for interior use only. Please follow these guidelines to maintain the appearance and beauty of our kitchen cabinetry.

- Avoid prolonged exposure to direct sunlight. •

Self-cleaning appliances generate intense heat during a cleaning cycle. FERMAWOOD recommends the removal of doors and/or drawers from cabinets adjacent to or directly above an appliance during a cleaning cycle. This will help prevent possible damage to the finish or surface of these cabinets.

Avoid prolonged exposure to direct sunlight. Cabinetry can discolor, either lightening or darkening due to light exposure, natural from sunlight or artificial. Age, lighting, and exposure to the elements all have an expected and natural effect on cabinetry and are not considered to be manufacturer's defects.

Clean with a mild household detergent and non-abrasive lint free cloth. Most common stains should

be easily removed. (NOTE: Avoid using any corrosive chemicals such as bathroom or toilet cleaners which may permanently damage the surface) After cleaning, wipe off all residue with clean warm water. • Avoid contact with sharp or abrasive objects. The thermos fused laminated surface is designed to be resistant to minor scratches but can be damaged if excessive force is applied to the surface. Always cover the surface first prior to placing any sharp or abrasive objects on the surface. • Avoid contact with any hot surfaces. TFL is resistant to heat but any prolonged exposure to heat may cause permanent damage to the surface. Always use a protective pad to minimize the exposure to heat damage.

- ◆ Because wood products shrink and expand with changes in humidity, some control of interior temperature and humidity, where cabinetry is installed, should be in place to minimize the changes. Average temperature: 55F to 85F / Average relative humidity: 35% - 55%

CLEANING PRODUCTS TO AVOID

The following cleaning products are to be avoided as damage may occur:

- ◆ Harsh detergents, strong soaps, abrasive cleaning products such as tub and sink cleansers, scouring powder, steel wool or self polishing waxes, scouring pads, steel wool, or rough sides of sponges – it may seem obvious to avoid using these products, but once in a while you may consider using them to remove stubborn stains. More than likely, they will damage your cabinetry surface.
- ◆ Sponges or dish cloths. They may contain particles that could scratch your cabinets, or they may contain food and oil residue or remnants of harsh cleaning solutions.
- ◆ Solvent-based or petroleum-based products such as mineral spirits, nail-polish removers or paint thinners, Ammonia or cleaning products that include ammonia., bleach or other harsh cleaning products.

SPLATTERS AND SPILLS

Clean spills and splatters immediately. Prolonged exposure to spills, including food, water or other liquids, or to oil and grease splatters, can cause permanent discoloration or damage to your cabinet's finish. Also avoid hanging dish towels in contact with cabinet surface. Towels can contain moisture, grease, or other that may harm the cabinetry.



CARE AND MAINTENANCE

www.fermawoodcabinetry.com

sales@fermawoodcabinetry.com

83 Mayfield Ave., Edison, New Jersey 08837

Toll Free: 1-877-FERMA-28

Toll Free FAX: 1-888-900-0686

| Tel: 732-225 5200 | Fax: 732-225 5290

This warranty is effective on all cabinets under the brand name of Signature Impressions, FERMAWOOD CABINETRY ("the Cabinet Products"), in the Traditional Series and, or Contemporary series, that is distributed by FERMA FLOORING ("FERMA") in the United States. This warranty is subject to all limitations, exclusions, disclaimers and procedures set forth herein. FERMAWOOD CABINETRY is warranted for to residential use only, and does not cover or apply for commercial applications or rental multi-family dwellings.

All Signature Impressions, FERMAWOOD CABINETRY ("the Cabinet Products"), purchased from FERMAWOOD are warranted by to the original purchasing consumer for 5 years from the date of the original purchase or as long as the original purchasing consumer owns the home, whichever is less, against unnatural defects in material and workmanship under normal residential use. Any usage of the cabinet products other than for residential purpose is not covered under this warranty. This warranty is non-transferable and does not cover cabinet products sold or shipped outside of the United States

CLAIMS: To submit a claim covered under this warranty, the original proof of purchase or a copy must be provided. Please email all documents with pictures stating and showing defects for said claim to FERMAWOOD Cabinetry at: sales@signaturecabinets.com

Warranty Exclusions:

When a claim for warpage/joint separation/wood growth is submitted, FERMAWOOD Cabinetry may, at its sole option and after inspection, defer action for up to 12 months to allow the Product to acclimate to the installed environment. These issues may be associated with indoor temperature and humidity levels outside of our specified recommendations, in our care and maintenance guidelines. Warpage or bowing due to excessive weight of stored items inside the cabinetry, will not be considered as a defect.

NOTE: Please do not send back any items to FERMAWOOD Cabinetry prior to receiving proper authorization.

EXCLUSIONS:

This warranty constitutes an exclusive remedy against the cabinet products for all defects, damages and workmanship. There are no implied warranties extending beyond the terms of this warranty.

FERMAWOOD Cabinetry shall not be liable for any incidental or consequential costs, expenses or damages. This warranty does not cover problems caused by any unauthorized services, improper installation of the cabinet products, and cabinetwork, drawer slides or hinges. This warranty does not cover items that have been modified from its original form.

Not covered under this warranty are flooring, tile, sinks, accessories, counter tops, appliances, plumbing fixtures, etc. or the costs, including labor, to remove and reinstall materials and related components such as fittings, appliances, or any other related labor costs, etc. This warranty does not cover items that have been modified from its original form. This warranty does not cover any product used or in-stalled in connection with cabinets, such as gas or electric appliances, countertops, or plumbing fixtures. Furthermore, the warranty does not cover costs associated with shipping or transportation of re-placement components, removal or installation costs, loss of time, loss of use, loss of revenues, inconvenience or other incidental damages.

This warranty coverage excludes, and does not cover deterioration due to normal wear and tear, mold, mildew, damage by misuse, physical abuse, misuse, accidents, improper maintenance, scratches, scuffs, burns, stains, wipe marks on darker color surfaces; neglect, acts of God, exposure to moisture, water, floods, leaking plumbing, or extreme heat, abuse, heat damage, due to incorrect installation or use of the Product adjacent to ovens or hotplates or other high heat sources, including deformation, cracking, discoloration and scorching, applying excessive impact to or mishandling the Product, including the impact caused by objects scraped along, thrown or dropped on to the Product's surface; and other occurrences beyond the control of FERMAWOOD Cabinetry.

This Limited Warranty does not apply to Product: (i) installed outdoors; (ii) used for purposes for which it is not designed or intended by FERMAWOOD Cabinetry; (iii) which has been subjected to misuse, vandalism, abuse, negligence, or accident; (iv) which has been improperly stored (if Product must be stored, it should be covered and stored in a humidity/temperature controlled environment away from direct sunlight); (v) which has been improperly installed, cleaned or maintained; (vi) which has been subjected to improper temperature and/or humidity extremes (temperature outside the range of 55-85°F, humidity outside the range of 30%-55%).

Continued on next page



COVERAGE OF WARRANTY

www.fermawoodcabinetry.com

sales@fermawoodcabinetry.com

83 Mayfield Ave., Edison, New Jersey 08837

Toll Free: 1-877-FERMA-28

Toll Free FAX: 1-888-900-0686

| Tel: 732-225 5200 | Fax: 732-225 5290

Continued

Self-cleaning appliances generate intense heat during a cleaning cycle. FERMAWOOD recommends the removal of doors and/or drawers from cabinets adjacent to or directly above an appliance during a cleaning cycle. This will help prevent possible damage to the finish or surface of these cabinets.

Avoid prolonged exposure to direct sunlight. This warranty does not cover discoloration such as lightening or darkening due to light exposure, natural from sunlight or artificial. Age, lighting, and exposure to the elements all have an expected and natural effect on cabinetry and are not considered to be manufacturer's defects that are covered by this warranty.

Sunlight, smoke, and other environmental conditions may also affect the color and integrity of your finish over time. These variations are considered to be the nature of the material in relation to their environmental exposure and are not covered under this Limited Warranty. NOTE: Independent testing has shown that discoloration will develop on doors, drawers, and cabinet parts after continued exposure to tobacco smoke. This is apparent on white and lighter finishes. We do not warrant discoloration in our products due to exposure to tobacco smoke.

Certain household cleaners and other substances may also affect the color and integrity of the Product's finish over time. Any such effects on the color and/or integrity of the finish over time are not covered by this Limited Warranty. No contractor, retailer, and agent or employee of FERMAWOOD Cabinetry has the authority to alter obligations or limitations in this warranty.

This warranty constitutes the exclusive remedy against FERMAWOOD Cabinetry for all defects, damages and workmanship. There are no implied warranties extending beyond the terms of this warranty. FERMAWOOD Cabinetry shall not be liable for any incidental or consequential costs, expenses or damages. This warranty gives you specific legal rights, and you may also have other rights, which vary from state to state. It is possible that one or more of the limitations and exclusions in this warranty may not apply to you.

WOOD AND COLOR VARIATIONS (FERMAWOOD Cabinetry Traditional Series)

Wood is a product of nature, and since no two trees are alike, cabinets may vary in color, texture and grain. Wood characteristics naturally occurring such as variations in color, grain, mineral streaks, pinholes and knots are not considered defects. Color variations in cabinets are also a natural occurrence due to species, age, character of cabinets, and exposure to UV light and sunlight. For these reasons, new and/or replacement cabinets may not match display samples and/or existing cabinets. This may result in overall color variations, but is not considered a defect. **GLAZED FINISHES:** A glazed finish by character is an uneven finish. Some edges and profiles will have heavier hang up than others and glazing may vary from cabinet to cabinet, door to drawer and item to item. This may result in overall color variations but is not considered a defect. **PAINTED FINISHES:** Wood by nature will undergo expansion and contraction movements year after year as it compensates and adjusts

to ever changing atmospheric humidity and temperature conditions. As such, finish stress lines may become visible on painted cabinets especially at the joints. Any such occurrence is not considered a defect.

WARRANTY PERFORMANCE

If a defect does occur within the terms and conditions of this warranty, such defective part will be re-paired or replaced by FERMAWOOD Cabinetry, at its sole discretion. FERMAWOOD Cabinetry will not provide or pay for the cost of removal of defective product, transportation of defective, repaired or replaced product or installation of repaired or replaced product. FERMAWOOD Cabinetry will not be responsible for any shipping damages to the defective, replaced or repaired product. If defective item has been discontinued or is not available at the time, FERMAWOOD Cabinetry reserves the right to replace the item with the most similar item available at that time. FERMAWOOD Cabinetry may require at its discretion that the customer submit a clear photo, or that a company representative view the item being claimed before honoring this warranty.

THIS WARRANTY DOES NOT APPLY TO DISCONTINUED ITEMS, CLOSE OUT ITEMS, OR ITEMS SOLD "AS IS." ALL SUCH PRODUCTS ARE SOLD "AS IS" AND SHALL NOT HAVE ANY WARRANTY OF ANY KIND, INCLUDING, BUT NOT LIMITED TO, ANY EXPRESS WARRANTIES, IMPLIED WARRANTIES, WARRANTIES OF MERCHANTABILITY (EXPRESS OR IMPLIED), WARRANTIES OF FITNESS FOR A PARTICULAR PURPOSE (EXPRESS OR IMPLIED), OR ANY OTHER WARRANTIES REQUIRED BY LAW OR FACT.

FERMAWOOD CABINETRY, and its Affiliates, DISCLAIMS ALL OTHER WARRANTIES WHATSOEVER, EXPRESSED OR IMPLIED, INCLUDING ANY WARRANTY OF MERCHANTABILITY OR FITNESS FOR A PARTICULAR PURPOSE. IN NO EVENT SHALL FERMAWOOD CABINETRY HAVE ANY OTHER LIABILITY OR ANY MONETARY LIABILITY TO BUYER IN EXCESS OF THE PURCHASE PRICE OF THE FERMAWOOD CABINETRY PRODUCT ONLY. FERMAWOOD CABINETRY EXPRESSLY EXCLUDES AND SHALL NOT BE RESPONSIBLE FOR INCIDENTAL OR CONSEQUENTIAL DAMAGES OF ANY KIND. THE WARRANTY DOES NOT APPLY IN ANY STATE WHICH DOES NOT ALLOW EXCLUSION OR LIMITATION OF INCIDENTAL OR CONSEQUENTIAL DAMAGES. The warranty shall be governed by and construed in accordance with the laws of the state of New Jersey. Any action brought in seeking the resolution of any controversy arising out of or relating to the warranty shall be brought in the courts of the state of New Jersey.



COVERAGE OF WARRANTY

www.fermawoodcabinetry.com

sales@fermawoodcabinetry.com

83 Mayfield Ave., Edison, New Jersey 08837

Toll Free: 1-877-FERMA-28

Toll Free FAX: 1-888-900-0686

| Tel: 732-225 5200 | Fax: 732-225 5290