

FER·MA®

FERMAWOOD CABINETRY

Adornus
Cabinetry

Distributed by
FERMA FLOORING

www.fermaflooring.com

sales@fermaflooring.com

83 Mayfield Ave. Edison NJ 08837 | Tel: 732-225-5200 | Fax: 732-225-5290 | Toll Free Phone: 1-877-FERMA-28

FERMAWOOD INDEX OF CABINETRY

TRADITIONAL SERIES

Wood Trends Collection

| Style Name | Price Group | Model # |
|------------|-------------|---------|
| PRESTIGE | A | AW-P |
| SAHARA | A | AW-S |
| CAMDEN | B | AW-C |
| LEXINGTON | B | AW-L |
| ROCKPORT | B | AW-R |
| TOSCANA | B | AW-T |
| ASPEN | C | AW-A |
| BOARDWALK | C | AW-B |
| HAMPTON | C | AW-H |
| MADISON | C | AW-M |

CONTEMPORARY SERIES

High Gloss Collection

| Style Name | Price Group | Model # |
|--------------|-------------|---------|
| ARTIKA | D | AL-ART |
| EBONY | D | AL-EBO |
| ELM | D | AL-ELM |
| GABON WALNUT | D | AL-GAB |
| KAPUCINO | D | AL-KAP |
| KREME | D | AL-KRE |
| LIGHT WALNUT | D | AL-LIG |
| ZAMBA | D | AL-ZAM |

Matte Finish Collection

| Style Name | Price Group | Model # |
|---------------|-------------|---------|
| AMACFI | D | AL-AMA |
| ASPEN OAK | D | AL-ASP |
| CAFE | D | AL-CAF |
| CAPRI | D | AL-CAP |
| CARBONE | D | AL-CAR |
| CITY OAK | D | AL-CIT |
| MACASSARO | D | AL-MAC |
| NOCE DANIELLA | D | AL-NOC |
| PALISSANDRO | D | AL-PAL |
| PINE BIANCO | D | AL-PIN |
| RIALTO | D | AL-RIA |
| ROVERE | D | AL-ROV |
| RUSTICA | D | AL-RUS |
| SPIAGGA | D | AL-SPI |
| TERMITI | D | AL-TER |
| TROPEA | D | AL-TRO |

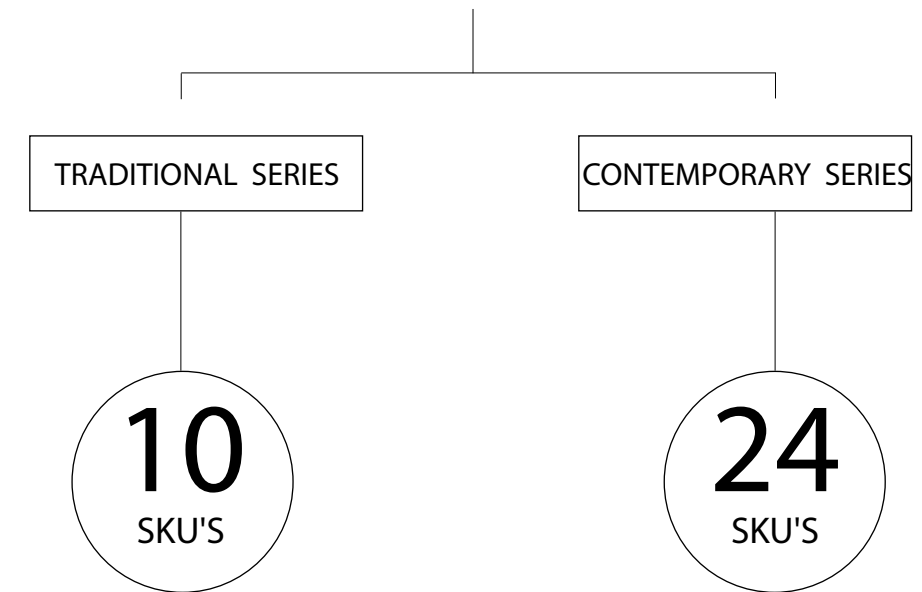

F E R M A W O O D
Wood Trends Collection
Traditional



PRESTIGE



SAHARA



LEXINGTON



CAMDEN



ROCKPORT



TUSCANA



HAMPTON



MADISON



ASPEN



BOARDWALK

FERMAWOOD

Wood Trends Collection

Traditional

Cabinet

Wood Trends Collection

| Style Name | Price Group | Model # |
|------------|-------------|---------|
| PRESTIGE | A | AW-P |
| SAHARA | A | AW-S |
| CAMDEN | B | AW-C |
| LEXINGTON | B | AW-L |
| ROCKPORT | B | AW-R |
| TOSCANA | B | AW-T |
| ASPEN | C | AW-A |
| BOARDWALK | C | AW-B |
| HAMPTON | C | AW-H |
| MADISON | C | AW-M |

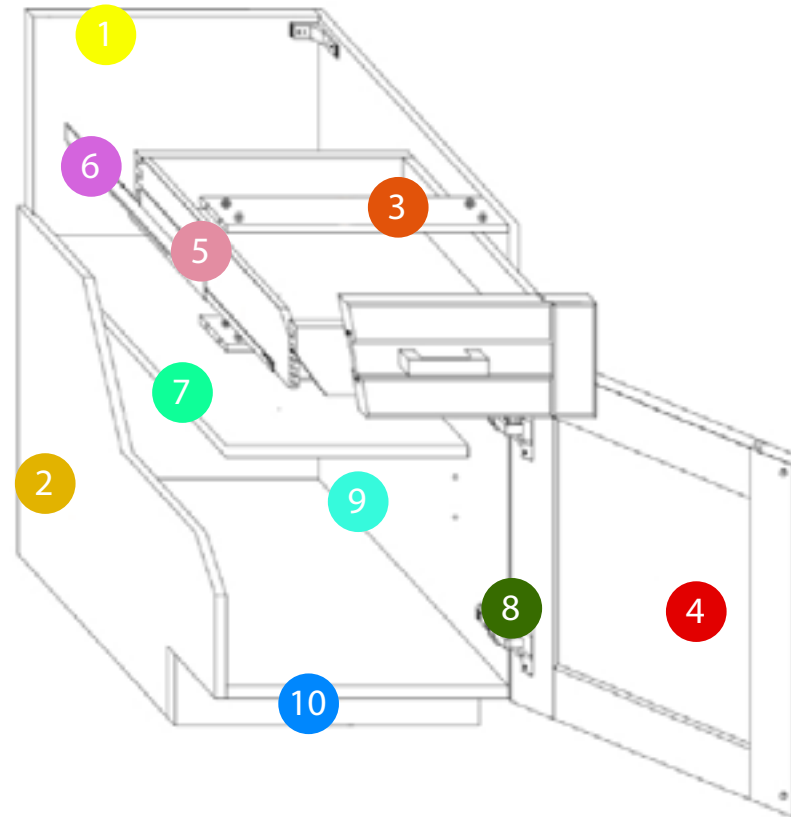

The cabinet boxes are finished with UV lacquer, which is durable, environmentally-friendly and free from formaldehyde and hazardous substances. UV lacquer hardens when exposed to ultraviolet light. This makes the lacquer completely harmless and gives an attractive and robust finish that can tolerate even the roughest treatment.

SOLID WOOD

- 1 Back of Cabinet**
 1/4" finished inside plywood with 1/2" x 2-1/2" framing. The plywood back is set into the side panels, which has dado cut channels. It is secured with screws and metal "L" brackets to the side panels.
- 2 3/4" Birch Plywood Construction**
 Side, bottom, and top (for wall cabinets). Edge banding for exposed sides.
- 3 Extra Support**
 3/4" Thick bridge to add strength to the cabinet.
- 4 Solid Wood Doors**
 3/4" true 5 piece construction. Reversed raised solid wood panel for all shaker doors.
- 5 Drawer Construction**
 Clear finished 5/8" solidwood, with dove tail connected drawer sides. Drawer bottoms are 1/4" plywood, which is set into dado cut channels on the 4 drawer sides.
- 6 Drawer Slides**
 Undermounted drawer slides, except on Prestige, which is side mounted. Soft closing drawers are on all models except Prestige and Sahara.
- 7 Adjustable Shelf**
 15" deep x 3/4" plywood, with PVC edge banding front and back.
- 8 Hinges**
 6 way adjustable 110 degree soft closing hinges, except on special cabinets, such as Lazy Susans, and diagonal corners. Soft closing is not available on Prestige and Sahara style.
- 9 Cabinet Joints**
 Dowel, Glued and clamped for all Wood Trend models, except Prestige, Lexington and Toscana, which has dowels and Cam-locks.
- 10 Toe Kick**
 3/4" with side edge banding.

PRESTIGE

Model #AW-P

FERMAWOOD
Wood Trends Collection
Traditional



**DOOR & DRAWER
FRONT WOOD SPECIES**

Maple

COLOR

Harvest Bronze

STYLE

Mitered Raised Panel / Full
Overlay Design

DESIGN

3/4" thick - Five Piece
Raised Panel Doors

**DOOR &
DRAWER FRONT**

2-1/2" wide stiles and
rails, with finger miter
joints

**DRAWER INSIDE
CONSTRUCTION**

Clear finished
5/8" solid wood,
with dove tail
connected drawer
sides. Drawer
bottoms are 1/4"
plywood, which is
set into dado cut
channels on the 4
drawer sides.

**DOOR & DRAWER FRONT
CENTER PANEL**

Solid wood center panel

**DOOR & DRAWER
FRONT FINISH**

Multi steps, finished with
two part post-catalyzed
conversion varnish, which
is very hard. It is also heat
and chemical resistant,
and has exceptional non
yellowing characteristics.
The same paint stain is
applied to the 3/4" Birch
plywood cabinet boxes,
inside and outside, and is
finished with UV lacquer

SAFETY DATA

No formaldehyde

PRICE LEVEL

A
Door & drawer
handles not
included



PRESTIGE

Model #AW-P

FER·MA[®]
FERMAWOOD CABINETS

Wood Trends Collection
Traditional

SAHARA

Model #AW-S

FERMAWOOD
Wood Trends Collection
Traditional



DOOR & DRAWER FRONT WOOD SPECIES

Maple

COLOR

Nutmeg, with a soft
chocolate glaze

STYLE

Raised Panel / Full Overlay
Design

DESIGN

3/4" thick - Five Piece
Raised Panel

DOOR & DRAWER FRONT

2-1/2" wide stiles and
rails, with tongue &
groove joints

DRAWER INSIDE CONSTRUCTION

Clear finished
5/8" solid wood,
with dove tail
connected drawer
sides. Drawer
bottoms are 1/4"
plywood, which is
set into dado cut
channels on the 4
drawer sides.

DOOR & DRAWER FRONT CENTER PANEL

Solid wood center panel

DOOR & DRAWER FRONT FINISH

Multi steps, finished with
two part post-catalyzed
conversion varnish, which
is very hard. It is also heat
and chemical resistant,
and has exceptional non
yellowing characteristics.
The same paint stain is
applied to the 3/4" Birch
plywood cabinet boxes,
inside and outside, and is
finished with UV lacquer

SAFETY DATA

No formaldehyde

PRICE LEVEL

A
Door & drawer
handles not
included





SAHARA

Model #AW-S

Wood Trends Collection

Traditional

LEXINGTON

Model #AW-L

FERMAWOOD
Wood Trends Collection
Traditional



DOOR & DRAWER
FRONT WOOD SPECIES

Alder

COLOR

Cherry

STYLE

Mitered Raised Panel / Full
Overlay Style

DESIGN

3/4" thick - Five Piece
Raised Panel Doors

DOOR &
DRAWER FRONT

3" wide stiles and
rails, with finger miter
joints

DRAWER INSIDE
CONSTRUCTION

Clear finished
5/8" solid wood,
with dove tail
connected drawer
sides. Drawer
bottoms are 1/4"
plywood, which is
set into dado cut
channels on the 4
drawer sides.

DOOR & DRAWER FRONT
CENTER PANEL

Solid wood center panel

DOOR & DRAWER
FRONT FINISH

Multi steps, finished with
two part post-catalyzed
conversion varnish, which
is very hard. It is also heat
and chemical resistant,
and has exceptional non
yellowing characteristics.
The same paint stain is
applied to the 3/4" Birch
plywood cabinet boxes,
inside and outside, and is
finished with UV lacquer

SAFETY DATA

No formaldehyde

PRICE LEVEL

B
Door & drawer
handles not
included



LEXINGTON

Model #AW-L

Wood Trends Collection
Traditional

CAMDEN

Model #AW-C

FERMAWOOD
Wood Trends Collection
Traditional



DOOR & DRAWER
FRONT WOOD SPECIES

Alder

COLOR

Glazed Walnut Finish

STYLE

Mitered Raised Panel Style
/ Full Overlay Design

DESIGN

3/4" thick - Five Piece
Raised Panel

DOOR &
DRAWER FRONT

3" wide stiles and
rails, with finger miter
joints

DRAWER INSIDE
CONSTRUCTION

Clear finished
5/8" solid wood,
with dove tail
connected drawer
sides. Drawer
bottoms are 1/4"
plywood, which is
set into dado cut
channels on the 4
drawer sides.

DOOR & DRAWER FRONT
CENTER PANEL

Solid wood center panel

DOOR & DRAWER
FRONT FINISH

Multi steps, finished with
two part post-catalyzed
conversion varnish, which
is very hard. It is also heat
and chemical resistant,
and has exceptional non
yellowing characteristics.
The same paint stain is
applied to the 3/4" Birch
plywood cabinet boxes,
inside and outside, and is
finished with UV lacquer

SAFETY DATA

No formaldehyde

PRICE LEVEL

B
Door & drawer
handles not
included



CAMDEN

Model #AW-C

Wood Trends Collection
Traditional

ROCKPORT

Model #AW-R

FERMAWOOD
Wood Trends Collection
Traditional



**DOOR & DRAWER
FRONT WOOD SPECIES**

Alder

COLOR

Cream Finish

STYLE

Mitered Raised Panel Style
/ Full Overlay Style

DESIGN

3/4" thick - Five Piece
Raised Panel

**DOOR &
DRAWER FRONT**

3" wide stiles and rails,
with finger miter joints

**DRAWER INSIDE
CONSTRUCTION**

Clear finished
5/8" solid wood,
with dove tail
connected drawer
sides. Drawer
bottoms are 1/4"
plywood, which is
set into dado cut
channels on the 4
drawer sides.

**DOOR & DRAWER FRONT
CENTER PANEL**

Solid wood center panel

**DOOR & DRAWER
FRONT FINISH**

Multi steps, finished with
two part post-catalyzed
conversion varnish, which
is very hard. It is also heat
and chemical resistant,
and has exceptional non
yellowing characteristics.
The same paint stain is
applied to the 3/4" Birch
plywood cabinet boxes,
inside and outside, and is
finished with UV lacquer

SAFETY DATA

No formaldehyde

PRICE LEVEL

B
Door & drawer
handles not
included



ROCKPORT

Model #AW-R

FER·MA[®]
FERMAWOOD CABINETS

Wood Trends Collection
Traditional

TOSCANA

Model #AW-T

FERMAWOOD
Wood Trends Collection
Traditional



DOOR & DRAWER
FRONT WOOD SPECIES

Alder

COLOR

Soft Walnut

STYLE

Shaker / Full Overlay

Design

DESIGN

3/4" thick - Five Piece

Reversed Raised Panel

Doors & Drawers

DOOR &
DRAWER FRONT

3" wide stiles and rails,
with tongue & groove
joints

DRAWER INSIDE
CONSTRUCTION

Clear finished
5/8" solid wood,
with dove tail
connected drawer
sides. Drawer
bottoms are 1/4"
plywood, which is
set into dado cut
channels on the 4
drawer sides.

DOOR & DRAWER FRONT
CENTER PANEL

Solid wood center panel

DOOR & DRAWER
FRONT FINISH

Multi steps, finished with
two part post-catalyzed
conversion varnish, which
is very hard. It is also heat
and chemical resistant,
and has exceptional non
yellowing characteristics.
The same paint stain is
applied to the 3/4" Birch
plywood cabinet boxes,
inside and outside, and is
finished with UV lacquer

SAFETY DATA

No formaldehyde

PRICE LEVEL

B

Door & drawer
handles not
included



TOSCANA

Model #AW-T

FER·MA[®]
FERMAWOOD CABINETS

Wood Trends Collection
Traditional

HAMPTON

Model #AW-H

FERMAWOOD
Wood Trends Collection
Traditional



**DOOR & DRAWER
FRONT WOOD SPECIES**

Alder

COLOR

White

STYLE

Shaker / Full Overlay

Design

DESIGN

3/4" thick - Five Piece
Reversed Raised Panel
Doors & Drawers

**DOOR &
DRAWER FRONT**

3" wide stiles and rails,
with tongue & groove
joints

**DRAWER INSIDE
CONSTRUCTION**

Clear finished
5/8" solid wood,
with dove tail
connected drawer
sides. Drawer
bottoms are 1/4"
plywood, which is
set into dado cut
channels on the 4
drawer sides.

**DOOR & DRAWER FRONT
CENTER PANEL**

Solid wood center panel

**DOOR & DRAWER
FRONT FINISH**

Multi steps, finished with
two part post-catalyzed
conversion varnish, which
is very hard. It is also heat
and chemical resistant,
and has exceptional non
yellowing characteristics.
The same paint stain is
applied to the 3/4" Birch
plywood cabinet boxes,
inside and outside, and is
finished with UV lacquer

SAFETY DATA

No formaldehyde

PRICE LEVEL

C
Door & drawer
handles not
included



HAMPTON

Model #AW-H

FER·MA[®]
FERMAWOOD CABINETRY

Wood Trends Collection
Traditional

MADISON

Model #AW-M

FERMAWOOD
Wood Trends Collection
Traditional



DOOR & DRAWER
FRONT WOOD SPECIES

Alder

COLOR

Espresso

STYLE

Shaker / Full Overlay
Design

DESIGN

3/4" thick - Five Piece
Reversed Raised Panel
Doors & Drawers

DOOR &
DRAWER FRONT

3" wide stiles and rails,
with tongue & groove
joints

DRAWER INSIDE
CONSTRUCTION

Clear finished
5/8" solid wood,
with dove tail
connected drawer
sides. Drawer
bottoms are 1/4"
plywood, which is
set into dado cut
channels on the 4
drawer sides.

DOOR & DRAWER FRONT
CENTER PANEL

Solid wood center panel

DOOR & DRAWER
FRONT FINISH

Multi steps, finished with
two part post-catalyzed
conversion varnish, which
is very hard. It is also heat
and chemical resistant,
and has exceptional non
yellowing characteristics.
The same paint stain is
applied to the 3/4" Birch
plywood cabinet boxes,
inside and outside, and is
finished with UV lacquer

SAFETY DATA

No formaldehyde

PRICE LEVEL

C
Door & drawer
handles not
included



MADISON

Model #AW-M

Wood Trends Collection
Traditional

ASPEN

Model #AW-A

FERMAWOOD Wood Trends Collection Traditional



DOOR & DRAWER FRONT WOOD SPECIES

Maple

COLOR

Warm White

STYLE

Raised Panel / Full Overlay
Style

DESIGN

3/4" thick - Five Piece
Raised Panel Doors

DOOR & DRAWER FRONT

2-1/2" wide stiles and
rails, with tongue &
groove joints

DRAWER INSIDE CONSTRUCTION

Clear finished
5/8" solid wood,
with dove tail
connected drawer
sides. Drawer
bottoms are 1/4"
plywood, which is
set into dado cut
channels on the 4
drawer sides.

DOOR & DRAWER FRONT CENTER PANEL

Solid wood center panel

DOOR & DRAWER FRONT FINISH

Multi steps, finished with
two part post-catalyzed
conversion varnish, which
is very hard. It is also heat
and chemical resistant,
and has exceptional non
yellowing characteristics.
The same paint stain is
applied to the 3/4" Birch
plywood cabinet boxes,
inside and outside, and is
finished with UV lacquer

SAFETY DATA

No formaldehyde

PRICE LEVEL

C
Door & drawer
handles not
included





ASPEN

Model #AW-A

FER·MA[®]
FERMAWOOD CABINETS

Wood Trends Collection
Traditional

BOARDWALK

Model #AW-S

FERMAWOOD
Wood Trends Collection
Traditional



DOOR & DRAWER
FRONT WOOD SPECIES

Alder

COLOR

Glazed Dark Walnut

STYLE

Raised Panel / Full Overlay
Style

DESIGN

3/4" thick - Five Piece
Raised Panel, in a soft
pillowed design

DOOR &
DRAWER FRONT

3" wide stiles and
rails, with finger miter
joints

DRAWER INSIDE
CONSTRUCTION

Clear finished
5/8" solid wood,
with dove tail
connected drawer
sides. Drawer
bottoms are 1/4"
plywood, which is
set into dado cut
channels on the 4
drawer sides.

DOOR & DRAWER FRONT
CENTER PANEL

Solid wood center panel

DOOR & DRAWER
FRONT FINISH

Multi steps, finished with
two part post-catalyzed
conversion varnish, which
is very hard. It is also heat
and chemical resistant,
and has exceptional non
yellowing characteristics.
The same paint stain is
applied to the 3/4" Birch
plywood cabinet boxes,
inside and outside, and is
finished with UV lacquer

SAFETY DATA

No formaldehyde

PRICE LEVEL

C
Door & drawer
handles not
included



BOARDWALK

Model #AW-S

FER·MA[®]
FERMAWOOD CABINETS

Wood Trends Collection
Traditional

FERMAWOOD
Wood Trends Collection
Traditional

Cabinet Accessories



ANGLE CROWN MOULDING



CLASSIC CROWN MOULDING



CLASSIC COVE MOULDING



CORBEL



CORBEL SHAKER



FLUTTED SQUARE POST



SPINDEL LEG



MULLION DOOR



BASE SPICE RACK



PULL OUT



BASE WINE RACK



WINE RACK

Cabinet Accessories

FERMAWOOD
Wood Trends Collection
Traditional



WALL CHINA DISPLAY



CLASSIC LIGHT MOULDING



SHAKER LIGHT MOULDING



BASE AND SHELF



WASTE BIN



LAZY SUSAN INSERTS

FERMAWOOD Wood Trends Collection Traditional

10' x 10' Kitchen Layout

| | List Price |
|---------|------------|
| Group A | \$6,818.00 |
| Group B | \$7,716.00 |
| Group C | \$8,484.00 |

Price for 10X10 kitchen

| Group A | Group B | Group C | Qty | User Code |
|------------|------------|------------|-----|-----------|
| 690.00 | 781.00 | 859.00 | 1 | W3630 |
| 501.00 | 567.00 | 624.00 | 1 | W2430 |
| 668.00 | 757.00 | 832.00 | 1 | AWC2430 |
| 318.00 | 360.00 | 396.00 | 1 | W1230 |
| 324.00 | 367.00 | 404.00 | 1 | W3012 |
| 390.00 | 442.00 | 486.00 | 1 | W1830 |
| 352.00 | 399.00 | 439.00 | 1 | W3612 |
| 414.00 | 469.00 | 516.00 | 1 | B12 |
| 779.00 | 882.00 | 971.00 | 1 | SB36 |
| 414.00 | 469.00 | 516.00 | 1 | B12 |
| 1,145.00 | 1,297.00 | 1427.00 | 1 | LS36 |
| 511.00 | 579.00 | 637.00 | 1 | B18 |
| 104.00 | 118.00 | 130.00 | 2 | TK96 |
| 168.00 | 189.00 | 207.00 | 3 | SM96 |
| 40.00 | 40.00 | 40.00 | 1 | TUK |
| List Price | List Price | List Price | | |
| \$6,818.00 | \$7,716.00 | \$8,484.00 | | |

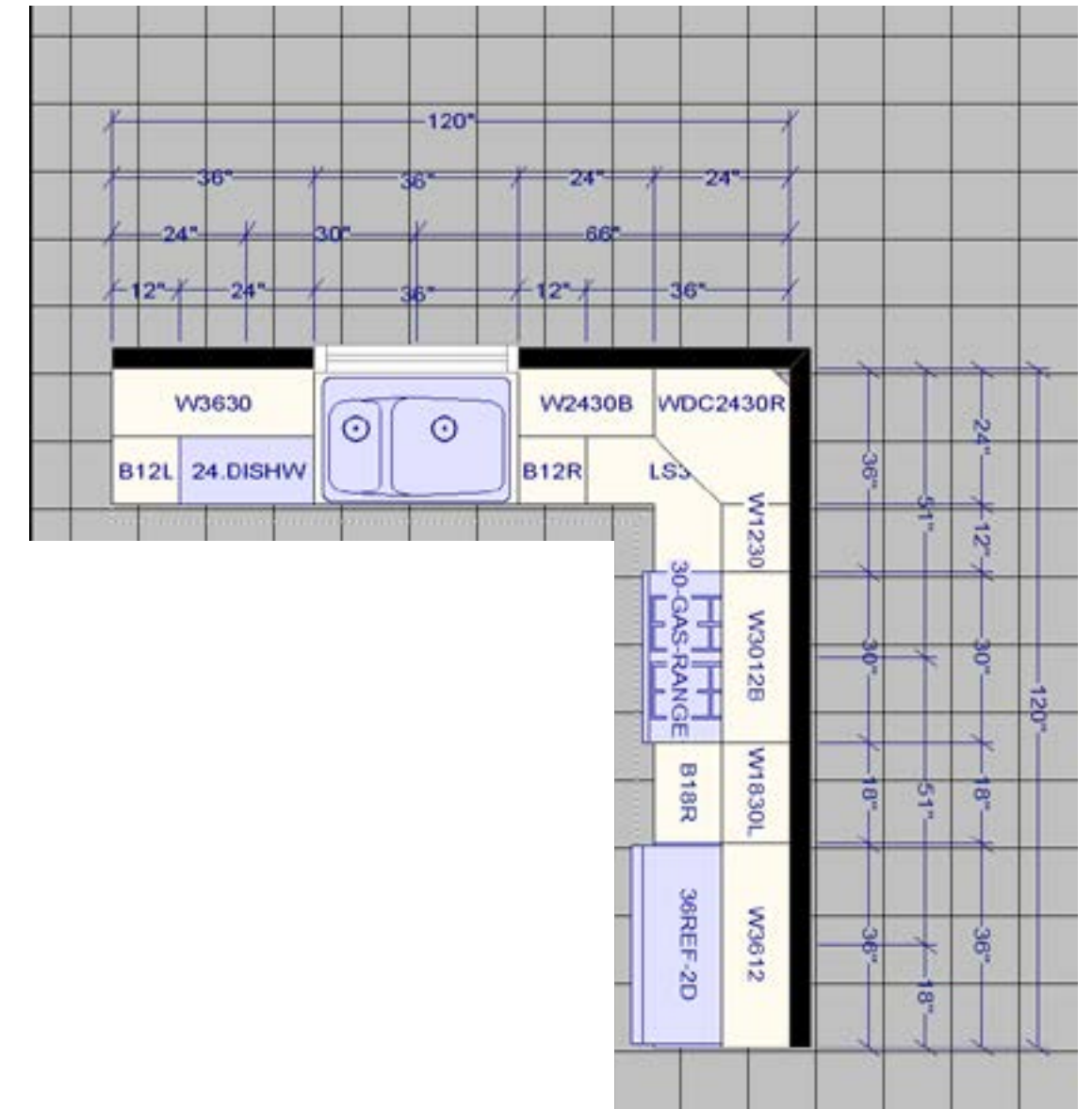
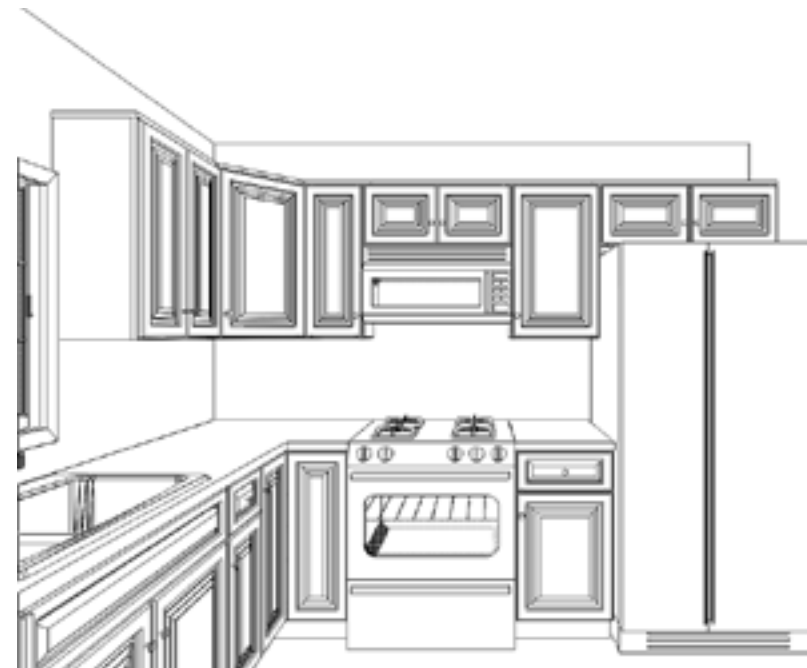

Kitchen Island Layout Concepts

FERMAWOOD Wood Trends Collection Traditional

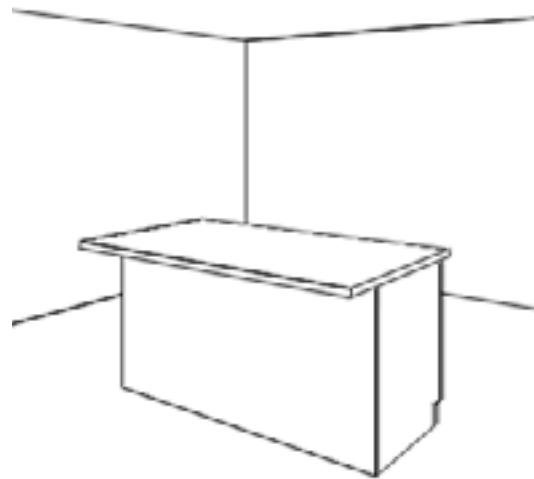

Price for Cabinets island 72"
kitchen island

| User Code | Item | Qty | Level A | Level B | Level C |
|-----------|-----------------------|-----|---------|---------|---------|
| B36 | B36 BASE | 1 | 791.00 | 896 | 986 |
| B36 | B36 BASE | 1 | 791.00 | 896 | 986 |
| FBP4896 | PNL1/4x4x8 | 1 | 240.00 | 272 | 299 |
| TK96 | TK8 FINISHED TOE KICK | 1 | 59.00 | 59 | 65 |
| OCM96 | OM8 OUTSIDE CNR MOLD | 1 | 80.00 | 90 | 99 |

List Price List Price List Price
\$1961.00 \$2213.00 \$2435

*Counter tops not included

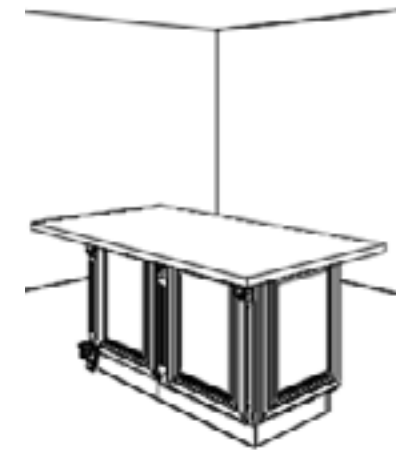

Price for Cabinets island 57"
kitchen island with decor

| User Code | Item | Qty | Level A | Level B | Level C |
|-----------|-----------------------|-----|----------|----------|---------|
| B27 | | 1 | 668.00 | 756.00 | 832.00 |
| B30 | | 1 | 710.00 | 804.00 | 885.00 |
| FBP4896 | PNL1/4x4x8 | 1 | 240.00 | 272.00 | 299.00 |
| TK96 | TK8 FINISHED TOE KICK | 1 | 59.00 | 59.00 | 65.00 |
| BDP2430 | | 4 | 1,038.00 | 1,176.00 | 1728.00 |
| FF330 | | 3 | 258.00 | 300.00 | 330.00 |
| OCM96 | | 1 | 80.00 | 90.00 | 99.00 |

List Price List Price List Price
\$3053.00 \$3457.00 \$4238.00

*Counter tops not included

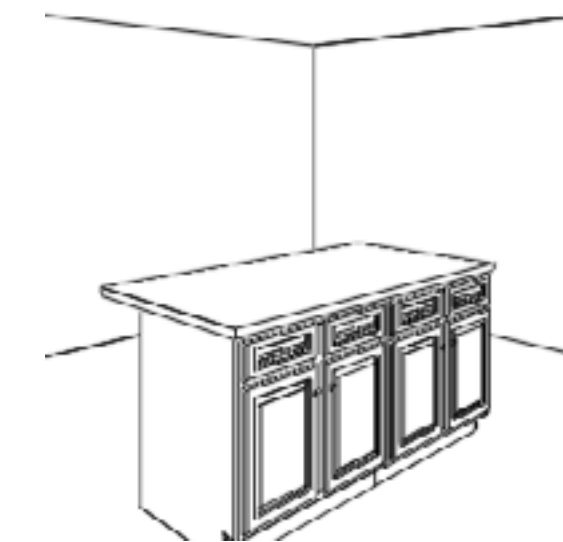

FERMAWOOD Comtemporary Series



AMACFI



ARTIKA



ASPEN OAK



CAFE



CAPRI



CARBONE



CITY OAK



EBONY



ELM



GABON WALNUT



KUPUCINO



KREME



LIGHT WALNUT



MACASSARO



NOCE DANIELLA



PALISSANDRO



PINE BLANCO



RIALTO



ROVERE



RUSTICA



SPIAGGA



TERMITI



TROPEA



ZAMBA

Showroom Display Racks



Item #WTD-10
Traditional Series - 10 Door Samples ONLY
Now Only \$99.

Item #WTD-10-2
Traditional Series - 10 Door / Drawer Samples ONLY
15"W X 22"H
Now Only \$249.



Item #CAT-S
Fermawood Cabinetry Standard Catalog
11"H X 17"W
Now Only \$70.

Item #CAT-PL
Fermawood Cabinetry Private Label Catalog
11"H X 17"W
Now Only \$170.

F E R M A W O O D Wood Trends Traditional Series



Item #HB-5-10-K
Traditional Series - 10 Doors on 5 Hand Boards
17-5/8"W X 27-7/8"H each
Now Only \$149.



Item #JIG-1-14-K
Traditional Series - 10 Door Sample Display
28"W X 36-1/4"D X 72"H
Now Only \$299.



Item #JIG-1-14-K2
Traditional Series
10 Door / Drawer Sample Display
20"W X 36-1/4"D X 68-1/2"H
Now Only \$399.



Item #PY-1-14-K2
Traditional Series - 10 Door / Drawer Sample Display
20"W X 28-3/4"D X 74-3/4"H
Now Only \$379.



FER·MA[®]

FERMAWOOD CABINETRY



www.fermaflooring.com

sales@fermaflooring.com

83 Mayfield Ave. Edison NJ 08837

Tel: 732-225-5200 | Fax: 732-225-5290 | Toll Free Phone: 1-877-FERMA-28